

NOTICE!!

These documents have been scanned!

Do not place un-scanned documents beneath this notice!

Do not remove this notice from this file!

GPO Jacket No. 560-102
Print Order 61540
Rise Business Services, LLC
Job=AZ15 5/22/2019



Box Number= AZ15079



Claim Begin-End: AMC394708-AMC394711

1 Initial Receipt



AZ15079-13

AMC394407-AMC394878

United States Department of the Interior
Bureau of Land Management
 BUSINESS & SUPPORT SVCS DIV
 ONE N CENTRAL AVE SUITE 800
 PHOENIX, AZ 85004 -4427
 Phone: (602) 417-9200

Receipt

No: 1790394

Transaction #: 1848484		ENTERED INTO COMPUTER
Date of Transaction: 09/22/2008		
CUSTOMER:	MAUREEN WALSH 6082 N MOONLIGHT DR LAS VEGAS, NV 89130	SEP 29 2008 <i>PB</i>

LINE #	QTY	DESCRIPTION	REMARKS	UNIT PRICE	TOTAL
1	4.00	LOCATABLE MINERALS / MINING CLAIMS- NEW, UNADJUD, ONE OR MORE AUTH NOS / NEW MINING CLAIM PROCESSING FEE \$15 (1930) CASES: AMC394708/\$15.00, AMC394709/\$15.00, AMC394710/\$15.00, AMC394711/\$15.00		- n/a -	60.00
2	4.00	LOCATABLE MINERALS / MINING CLAIMS- NEW, UNADJUD, ONE OR MORE AUTH NOS / NEW MINING CLAIM LOCATION FEE \$30 (1993) CASES: AMC394708/\$30.00, AMC394709/\$30.00, AMC394710/\$30.00, AMC394711/\$30.00		- n/a -	120.00
3	4.00	LOCATABLE MINERALS / MINING CLAIMS- NEW, UNADJUD, ONE OR MORE AUTH NOS / NEW MINING CLM MAINT FEE \$125 (1993) CASES: AMC394708/\$125.00, AMC394709/\$125.00, AMC394710/\$125.00, AMC394711/\$125.00		- n/a -	500.00
TOTAL:					\$680.00

PAYMENT INFORMATION			
1	AMOUNT:	\$680.00	POSTMARKED: N/A
	TYPE:	CHECK	RECEIVED: 09/22/2008
	CHECK NO:	3353	
	NAME:	WALSH, MAUREEN 6082 N MOONLIGHT DR LAS VEGAS NV 89130	

REMARKS

This receipt was generated by the automated BLM Collections and Billing System and is a paper representation of a portion of the official electronic record contained therein.

NOTICE!!

These documents have been scanned!

Do not place un-scanned documents beneath this notice!

Do not remove this notice from this file!

GPO Jacket No. 560-102
Print Order 61540
Rise Business Services, LLC
Job=AZ15 5/22/2019



Box Number= AZ15079



Claim Begin-End: AMC394708-AMC394711

2 Correspondence



AZ15079-13

AMC394407-AMC394878

**NO
DOCUMENTS
FOUND**

NO DOCUMENTS FOUND
NO DOCUMENTS FOUND

NOTICE!!

These documents have been scanned!

Do not place un-scanned documents beneath this notice!

Do not remove this notice from this file!

GPO Jacket No. 560-102
Print Order 61540
Rise Business Services, LLC
Job=AZ15 5/22/2019



Box Number= AZ15079



Claim Begin-End: AMC394708-AMC394711

3 Transfers



AZ15079-13

AMC394407-AMC394878

**NO
DOCUMENTS
FOUND**

NO DOCUMENTS FOUND
NO DOCUMENTS FOUND

NOTICE!!

These documents have been scanned!

Do not place un-scanned documents beneath this notice!

Do not remove this notice from this file!

GPO Jacket No. 560-102
Print Order 61540
Rise Business Services, LLC
Job=AZ15 5/22/2019



Box Number= AZ15079



Claim Begin-End: AMC394708-AMC394711

4 Annual Filings

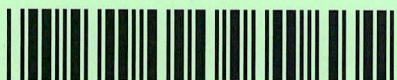

AZ15079-13

AMC394407-AMC394878

UNITED STATES
DEPARTMENT OF THE INTERIOR
BUREAU OF LAND MANAGEMENT

MAINTENANCE FEE WAIVER CERTIFICATION

SEE INSTRUCTIONS ON PAGE 2

127
[Signature]

364455
363097
364338

FORM APPROVED 364822
OMB NO. 1004-0114
Expires: January 31, 2020 394708

- This small miner waiver is filed for the assessment year beginning on September 1, 2019 and ending on September 1, 2020.
- The undersigned and all related parties owned ten or fewer mining claims, mill, or tunnel sites located and maintained on Federal lands in the United States of America on September 1, 2019.
- The undersigned have performed the assessment work required by law for each mining claim listed prior to filing this waiver and understand that by filing this form, the undersigned must file an affidavit of assessment work with the Bureau of Land Management (BLM) by the December 30th following the filing of this waiver.
- The undersigned understand that if the assessment work obligation has not yet come due under 30 U.S.C. 28 (for those claims in their first assessment year only), a notice of intent to hold reciting this condition must be recorded by the December 30th following the filing of this waiver.
- The undersigned understand that mill and tunnel sites may also be listed on this waiver and be waived from payment of the maintenance fee, and that a notice of intent to hold for these sites is required to be filed with the BLM by the December 30th following the filing of this waiver.
- The undersigned understand and acknowledge that pursuant to 43 U.S.C. 1212 and 18 U.S.C. 1001, the filing or recording of a false, fictitious, or fraudulent document with the BLM may result in a fine of up to \$250,000, a prison term not to exceed five years, or both.
- The mining claims, mill or tunnel sites for which this waiver from payment of the maintenance fees is requested are:

CLAIM OR SITE NAME	BLM RECORDATION SERIAL NUMBER	
1. <u>Brucote #1</u>	<u>364455</u>	✓
2. <u>Golden Gate</u>	<u>363097</u>	
3. <u>Banner</u>	<u>363098</u>	✓
4. <u>Mitchell #1</u>	<u>364338</u>	2019 AUG-8 P 3:10 ✓
5. <u>Mitchell #2</u>	<u>364339</u>	✓
6. <u>Mitchell #3</u>	<u>364822</u>	✓
7. <u>Mitchell No 4</u>	<u>394709</u>	
8. <u>Mitchell No 5</u>	<u>394710</u>	
9. <u>Leland No 4</u>	<u>394708</u>	
10. <u>Leland No 3</u>	<u>394711</u>	

The owner(s) (claimants) of the above mining claims and sites are:

<u>Maureen Walsh</u> (Owner's Name - Please Print)	<u>Maureen Walsh</u> (Owner's Signature)
<u>6082 Moonlight Dr</u> (Owner's Mailing Address)	<u>Las Vegas</u> <u>NV</u> <u>89130</u> (City) (State) (Zip Code)
_____ (Owner's Name - Please Print)	_____ (Owner's Signature)
_____ (Owner's Mailing Address)	_____ (City) (State) (Zip Code)
_____ (Owner's Name - Please Print)	_____ (Owner's Signature)
_____ (Owner's Mailing Address)	_____ (City) (State) (Zip Code)
_____ (Owner's Name - Please Print)	_____ (Owner's Signature)
_____ (Owner's Mailing Address)	_____ (City) (State) (Zip Code)

ENTERED
ST-11-10-19
[Signature]

Nw mg

(Owner's Name - Please Print)	(Owner's Signature)
(Owner's Mailing Address)	(City) (State) (Zip Code)
(Owner's Name - Please Print)	(Owner's Signature)
(Owner's Mailing Address)	(City) (State) (Zip Code)
(Owner's Name - Please Print)	(Owner's Signature)
(Owner's Mailing Address)	(City) (State) (Zip Code)
(Owner's Name - Please Print)	(Owner's Signature)
(Owner's Mailing Address)	(City) (State) (Zip Code)

18 U.S.C. 1001 and 43 U.S.C. 1212 make it a crime for any person knowingly and willfully to make to any department or agency of the United States any false, fictitious or fraudulent statements or representations as to any matter within its jurisdiction.

INSTRUCTIONS

1. This certification is made under the provisions of 43 U.S.C. § 1744 and 30 U.S.C. §28-28k and the regulations thereunder (43 CFR Part 3830).
2. The claimant(s) must fill in the dates in paragraph 1 for the beginning and ending of the assessment year for which this waiver is sought.
3. The claimant(s) must fill in the date in paragraph 2 for the beginning of the assessment year for which this waiver is sought.
4. All claim and site names and BLM serial numbers must be listed for the mining claims, mill sites, and tunnel sites for which the waiver is sought.
5. All owners of the mining claims, mill sites, and tunnel sites and their addresses must be given.
6. This waiver form must be signed by all the claimants or their designated agent, in original form. If an agent is designated, a notarized designation of agent, signed by all of the claimants with proper address given, must be submitted with this waiver.
7. This form must be filed no later than September 1st for the upcoming assessment year in the BLM State Office where the mining claims or sites are recorded, or the waiver cannot be granted by the BLM. (Example: To obtain a waiver for the assessment year 2012, which begins on September 1, 2011, you must qualify for and file for a waiver no later than September 1, 2011, in the proper BLM State Office.)
8. For all mining claims which require assessment work, you must record an affidavit of labor on or before the December 30th immediately following the filing of this waiver. For all other mining claims or sites waived, you must record a notice of intent to hold on or before the December 30th immediately following the filing of this waiver.
9. Mill and tunnel sites may also be listed on this waiver and be waived from payment of the maintenance fee. A notice of intent to hold for these sites is required to be filed by the December 30th following the filing of this waiver.

FOR OFFICIAL USE ONLY

UNITED STATES
DEPARTMENT OF THE INTERIOR
BUREAU OF LAND MANAGEMENT

Amc 364455
Amc 363097
Amc 364338

FORM APPROVED
OMB NO.: 1004-0114
Expires: January 31, 2020

AFFIDAVIT OF ANNUAL ASSESSMENT WORK

Amc 364822
Amc 394708

WHEN RECORDED, MAIL DOCUMENT TO:

NAME: Maureen Walsh
ADDRESS: 6082 Moonlight Dr
CITY, STATE, ZIP: Las Vegas, NV
89130

FEE# 2017043020

OFFICIAL RECORDS
OF MOHAVE COUNTY
KRISTI BLAIR,
COUNTY RECORDER



09/07/2017 12:29 PM Fee: \$15.00

PAGE: 1 of 4

FOR COUNTY RECORDER'S USE

No. of Claims 10
x \$10/claim
Total due BLM \$ 100.00

TO ALL WHOM IT MAY CONCERN:

1. The undersigned certifies that at least \$100 per claim was expended for development, labor and improvements, or equivalent value added, as the annual assessment work for the assessment year ending September 1, 2017 for the following contiguous unpatented mining claim(s), located in the County of Mohave, in the State of Arizona.

BLM Serial No.	Name of Claim	Tp	Rg	Sec	Mer	County Recordation Book and Page No.	Co. Recording Date
364455	Brucite #1	1917	20W	7SE 8SW	14	B:5415 P: 210	12/25/04
363097	Golden Gate	19N	20W	20NE 20NW	14	B:5330 P: 769	11/2/04
363098	Banner	19N	20W	20NE 20NW	14	B:5330 P: 771	11/2/04
364338	Mitchell #1	19N	20W	20NW	14	B:5413 P: 513	1/3/05
364339	Mitchell #2	19N	20W	20NW NE	14	B:5413 P: 511	1/3/05
364822	Mitchell #3	19N	20W	20NE 20NW SW SE	14	B:5539 P: 798	3/17/05
394709	Mitchell No 4	19N	20W	20NW	14	B:7320 P: 786	9/2/08
394710	Mitchell No 5	19N	20W	20NW SW	14	B:7320 P: 788	9/2/08
394708	Leland No 4	19N	20W	17SW 20NW	14	B:7320 P: 784	9/2/08
394711	Leland No 3	19N	20W	17SW SE	14	B:7320 P: 782	9/2/08

RECEIVED
 STATE OFFICE
 SEP 28 P 2:58
 PHOENIX, ARIZONA

ENTERED
 BY: AT

2. Type of labor and improvements (specify what was done and give the total value for that labor and improvement to show at least \$100 for each claim). If a geological, geochemical, or geophysical survey was performed, as per 30 U.S.C. 28-1, reference the title of the report of survey, give cost and date of the survey and report, and indicate it was filed with the County Recorder:

Description of Work Performed	Value of Work Performed	Date Work Was Performed
Recirculating mine sluice Bluebow	1800.00	Oct - May
Repair flood damaged roads	600.00	Oct - May
Clear brush for fire suppression	200.00	Apr - May

3. Name and mailing address of each person who performed the labor and improvements:

Name (please print)

Maureen Walsh

Current Mailing Address (please print)

6082 Moonlight Dr, Las Vegas, NV 89130

4. Name and mailing address of each person who holds and claims the subject mining claim(s) for the valuable minerals contained therein. Be sure to indicate if there is a change of address:

Name (please print)

Maureen Walsh

Current Mailing Address (please print)

6082 Moonlight Dr, Las Vegas, NV 89130

RECEIVED
BLM STATE OFFICE
2017 SEP 28 P 2:58
PHOENIX, ARIZONA

5. The undersigned testifies that on the date of August, 2017, all monuments required by law were erected upon the subject claim(s), and all notices required by law were posted on the subject claim(s) or copies thereof were in place, and at said date, each corner monument bore or contained

markings sufficient to appropriately designate the corner of the claim to which it pertains and the name of the claim(s).

I hereby certify under penalty of perjury under the laws of the State of Arizona that the foregoing statements are true and correct:

Maurice E. Walsh Date: 9-7-17
(Signature of person responsible for above statement)

Title 18 U.S.C. 1001 and 43 U.S.C. 1212 make it a crime for any person knowingly and willfully to make to any department or agency of the United States any false, fictitious or fraudulent statements or representations as to any matter within its jurisdiction.

Notary Block

SUBSCRIBED AND SWORN TO before me, this 7th day of September 20 17

By: Sydney Muhle
(Signature of Affiant)

Title: City Clerk, Notary Public

My Commission Expires: October 17, 2020

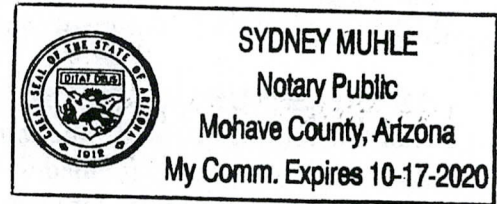

INSTRUCTIONS

1. This is an optional form that may be used to satisfy the requirements for the Bureau of Land Management (BLM) under the provisions of 43 U.S.C. §1744 and 30 U.S.C. §28-28d and the regulations thereunder (43 CFR part 3835). Since local and State laws may vary, you should contact your local and State agencies where the claims are located to ensure all applicable laws and requirements are satisfied.
2. The claimant(s) must fill in the date in paragraph 1 for the applicable assessment year and the county and state where the claims are located.
3. All claim names, BLM serial numbers, legal descriptions, and original county recording information must be listed for the claims pertaining to this assessment notice.
4. The claimant(s) must complete paragraph 2 listing all labor or improvements which was performed on or did benefit the subject mining claims. The value and date of the labor or improvements must also be listed. The total amount of labor or improvements can be listed, but the total expenditure must equal at least \$100 for each claim.
5. The names and current mailing addresses of the person(s) performing the labor shall be listed in paragraph 3.
6. The name and current mailing address of each owner (claimant) of the claims shall be listed in paragraph 4. The mailing address shall be the owner's address and not the address of an agent or anyone representing the claimant. Be sure to note if there has been a change of address.
7. Paragraph 5 shall be completed to show the date it was verified that all monuments required by law were properly erected, all notices were posted, and that corners were appropriately designated for all claims listed.
8. An exact legible reproduction or duplicate (other than microfilm or other electronic media) of this affidavit or another type of affidavit of assessment work that you file or will file in the county where each claim is located, must be filed with the BLM on or before December 30 of the calendar year in which the assessment year ends. For mill or tunnel sites, a separate notice of intent to hold must be filed with the BLM on or before December 30. Requirements for filing a notice of intent to hold can be found at 43 CFR 3835.33.
9. A processing fee of \$10 for each claim listed must be remitted to the BLM along with the or any other affidavit of assessment work.

RECEIVED
BLM
SEP 28 P 2:58
MOHAVE COUNTY
ARIZONA

NOTICES

THE PRIVACY ACT and 43 CFR 2.223(d) require that you be furnished with the following information in connection with the information requested by this form.

AUTHORITY: 30 U.S.C. §28-28d and 43 CFR part 3835 permit collection of the information requested by this form.

PRINCIPAL PURPOSE: The BLM will use the information you provide to document compliance with 43 U.S.C. 1744 and that assessment work has been completed in accordance with 30 U.S.C. § 28-28d and 43 CFR part 3835 in lieu of paying the maintenance fee for the mining claims listed on this form.

ROUTINE USES: The BLM will only disclose this information in accordance with the provisions at 43 CFR 2.231(b) and (c).

EFFECT OF NOT PROVIDING INFORMATION: Disclosure of the requested information is required by 30 U.S.C. § 28-28d and 43 CFR part 3835 for claimants qualified to perform assessment work in lieu of paying the maintenance fee. Failure to submit all the requested information or to complete this form will delay the BLM's processing of the form and may preclude the BLM's acceptance of the assessment work information, which may result in forfeiture of the mining claim(s) by the claimant.

THE PAPERWORK REDUCTION ACT requires us to inform you that:

Use of this form is optional. You must perform assessment if a waiver to pay the maintenance fee has been requested. This form is provided to help you attest that annual assessment work has been completed in lieu of paying the maintenance fee for your claim(s). Submission of the requested information is necessary to obtain or retain a benefit.

You do not have to respond to this or any other Federal agency-sponsored information collection unless it displays a valid OMB control number.

BURDEN HOURS STATEMENT: The estimated public reporting burden for this form is 30 minutes per response, including the time for reviewing instructions, gathering and maintaining data, and completing and reviewing the form. You may submit comments regarding the burden estimate or any other aspect of this form to: U.S. Department of the Interior, Bureau of Land Management (1004-0114), Bureau Information Collection Clearance Officer (WO-630), 1849 C Street, N.W., Room 2134LM, Washington, D.C. 20240.

RECEIVED
BLM AZ STATE OFFICE
2011 SEP 28 P 2:58
PHOENIX, ARIZONA

PRIORITY®
★ MAIL ★

FLAT RATE ENVELOPE
ONE RATE ★ ANY WEIGHT*

APPLY PRIORITY MAIL POSTAGE HERE



1024



85004

U.S. POSTAGE
PAID
LAS VEGAS, NV
89130
SEP 26, 17
AMOUNT

\$6.65

R2304H109543-10

Expected Delivery Day: 09/28/2017

USPS TRACKING NUMBER



9505 5100 4841 7269 2785 26

EP14H July 2013 Outer Dimension: 10 x 5

PRIORITY®
★ MAIL ★

FLAT RATE ENVELOPE
ONE RATE ★ ANY WEIGHT*



* Domestic only.

RECEIVED
BLM AZ STATE OFFICE
2017 SEP 28 P 2:57





PRESS FIRMLY TO SEAL

PRESS FIRMLY TO SEAL

PHOENIX, ARIZONA

PRIORITY®
★ MAIL ★



-  DATE OF DELIVERY SPECIFIED*
-  USPS TRACKING™ INCLUDED*
-  INSURANCE INCLUDED*
-  PICKUP AVAILABLE

* Domestic only

VISIT US AT USPS.COM®
ORDER FREE SUPPLIES ONLINE



PS00001000064

EP14H July 2013
OD: 10 x 5

EP14H © U.S. Postal Service, July 2013. All rights reserved.

This packaging is the property of the U.S. Postal Service® and is provided solely for use in sending Priority Mail® shipments. Misuse may be a violation of Federal law. This packaging is not for resale.

United States Department of the Interior
Bureau of Land Management
 DIV OF LANDS, MINRLS & ENERGY
 ONE N CENTRAL AVE
 PHOENIX, AZ 85004 -4427
 Phone: 602-417-9200

Receipt

No: 3986791

Transaction #: 4097012	
Date of Transaction: 09/29/2017	
CUSTOMER:	
MAUREEN WALSH 6082 MOONLIGHT DR LAS VEGAS,NV 89130-1017 US	

LINE #	QTY	DESCRIPTION	REMARKS	UNIT PRICE	TOTAL
1	1.00	LOCATABLE MINERALS / MINING CLAIMS- NOT NEW-UNADJUD,ONE AUTH NO. ONLY / MINING CLAIM MONEY RECEIVED CASES: AMC364455/\$100.00	POL 2017/10	- n/a -	100.00
TOTAL:					\$100.00

PAYMENT INFORMATION			
1	AMOUNT:	100.00	POSTMARKED: 09/26/2017
	TYPE:	CHECK	RECEIVED: 09/28/2017
	CHECK NO:	854	
	NAME:	WALSH, MAUREEN 6082 MOONLIGHT DR LAS VEGAS NV 89130-1017 US	

REMARKS

This receipt was generated by the automated BLM Collections and Billing System and is a paper representation of a portion of the official electronic record contained therein.

UNITED STATES
DEPARTMENT OF THE INTERIOR
BUREAU OF LAND MANAGEMENT
MAINTENANCE FEE WAIVER CERTIFICATION

FORM APPROVED
OMB NO. 1004-0114
Expires: January 31, 2020

SEE INSTRUCTIONS ON PAGE 2

364822

364455
363097
364338

39470

- This small miner waiver is filed for the assessment year beginning on September 1, 2018 and ending on September 1, 2019
- The undersigned and all related parties owned ten or fewer mining claims, mill, or tunnel sites located and maintained on Federal lands in the United States of America on September 1, 2019.
- The undersigned have performed the assessment work required by law for each mining claim listed prior to filing this waiver and understand that by filing this form, the undersigned must file an affidavit of assessment work with the Bureau of Land Management (BLM) by the December 30th following the filing of this waiver.
- The undersigned understand that if the assessment work obligation has not yet come due under 30 U.S.C. 28 (for those claims in their first assessment year only), a notice of intent to hold reciting this condition must be recorded by the December 30th following the filing of this waiver.
- The undersigned understand that mill and tunnel sites may also be listed on this waiver and be waived from payment of the maintenance fee, and that a notice of intent to hold for these sites is required to be filed with the BLM by the December 30th following the filing of this waiver.
- The undersigned understand and acknowledge that pursuant to 43 U.S.C. 1212 and 18 U.S.C. 1001, the filing or recording of a false, fictitious, or fraudulent document with the BLM may result in a fine of up to \$250,000, a prison term not to exceed five years, or both.
- The mining claims, mill or tunnel sites for which this waiver from payment of the maintenance fees is requested are:

CLAIM OR SITE NAME	BLM RECORDATION SERIAL NUMBER
1. Brucite #1	364455 (913)
2. Golden Gate	363097
3. Banner	363098
4. Mitchell #1	364338
5. Mitchell #2	364339
6. Mitchell #3	364822
7. Mitchell No 4	394709
8. Mitchell No 5	394710
9. Leland No 4	394708
10. Leland No 3	394711

The owner(s) (claimants) of the above mining claims and sites are:

Mauriceen Walsh
 (Owner's Name - Please Print)
 6082 Moonlight Dr
 (Owner's Mailing Address)

Mauriceen Walsh
 (Owner's Signature)
 Las Vegas NV 89130
 (City) (State) (Zip Code)

(Owner's Name - Please Print)

(Owner's Signature)

(Owner's Mailing Address)

(City) (State) (Zip Code)

(Owner's Name - Please Print)

(Owner's Signature)

(Owner's Mailing Address)

(City) (State) (Zip Code)

(Owner's Name - Please Print)

(Owner's Signature)

(Owner's Mailing Address)

(City) (State) (Zip Code)

(Continued on page 2)

ENTERED
 SEP 12 2018

BY: [Signature]

PHOENIX, ARIZONA
 2018 AUG 15 P 2:38
 BLM AZ STATE OFFICE
 RECEIVED

(Owner's Name - Please Print)	(Owner's Signature)		
(Owner's Mailing Address)	(City)	(State)	(Zip Code)
(Owner's Name - Please Print)	(Owner's Signature)		
(Owner's Mailing Address)	(City)	(State)	(Zip Code)
(Owner's Name - Please Print)	(Owner's Signature)		
(Owner's Mailing Address)	(City)	(State)	(Zip Code)
(Owner's Name - Please Print)	(Owner's Signature)		
(Owner's Mailing Address)	(City)	(State)	(Zip Code)

18 U.S.C. 1001 and 43 U.S.C. 1212 make it a crime for any person knowingly and willfully to make to any department or agency of the United States any false, fictitious or fraudulent statements or representations as to any matter within its jurisdiction.

INSTRUCTIONS

1. This certification is made under the provisions of 43 U.S.C. § 1744 and 30 U.S.C. §28-28k and the regulations thereunder (43 CFR Part 3830).
2. The claimant(s) must fill in the dates in paragraph 1 for the beginning and ending of the assessment year for which this waiver is sought.
3. The claimant(s) must fill in the date in paragraph 2 for the beginning of the assessment year for which this waiver is sought.
4. All claim and site names and BLM serial numbers must be listed for the mining claims, mill sites, and tunnel sites for which the waiver is sought.
5. All owners of the mining claims, mill sites, and tunnel sites and their addresses must be given.
6. This waiver form must be signed by all the claimants or their designated agent, in original form. If an agent is designated, a notarized designation of agent, signed by all of the claimants with proper address given, must be submitted with this waiver.
7. This form must be filed no later than September 1st for the upcoming assessment year in the BLM State Office where the mining claims or sites are recorded, or the waiver cannot be granted by the BLM. (Example: To obtain a waiver for the assessment year 2012, which begins on September 1, 2011, you must qualify for and file for a waiver no later than September 1, 2011, in the proper BLM State Office.)
8. For all mining claims which require assessment work, you must record an affidavit of labor on or before the December 30th immediately following the filing of this waiver. For all other mining claims or sites waived, you must record a notice of intent to hold on or before the December 30th immediately following the filing of this waiver.
9. Mill and tunnel sites may also be listed on this waiver and be waived from payment of the maintenance fee. A notice of intent to hold for these sites is required to be filed by the December 30th following the filing of this waiver.

FOR OFFICIAL USE ONLY

UNITED STATES
DEPARTMENT OF THE INTERIOR
BUREAU OF LAND MANAGEMENT

FORM APPROVED
OMB NO.: 1004-0114
Expires: January 31, 2020

3

AFFIDAVIT OF ANNUAL ASSESSMENT WORK

AMC 363097 364822
364338 394708
364455

WHEN RECORDED, MAIL DOCUMENT TO:

NAME: Maureen Walsh

ADDRESS: 6082 Moonlight Dr

CITY, STATE, ZIP: Las Vegas, NV
89130

FEE# 2018040006

OFFICIAL RECORDS
OF MOHAVE COUNTY
KRISTI BLAIR,
COUNTY RECORDER



08/13/2018 09:41 AM Fee: \$15.00

PAGE: 1 of 3

No. of Claims 10

x \$10/claim

Total due BLM \$ 100.00

TO ALL WHOM IT MAY CONCERN:

1. The undersigned certifies that at least \$100 per claim was expended for development, labor and improvements, or equivalent value added, as the annual assessment work for the assessment year ending September 1, 2018 for the following contiguous unpatented mining claim(s), located in the County of Mohave, in the State of Arizona.

RECEIVED
BLM AZ STATE OFFICE
2018 AUG 23 2:38 PM
HOENIG, ARIZONA

BLM Serial No.	Name of Claim	Tp Rg Sec Mer				County Recording Book and Page No.	Co. Recording Date
		Example: 13N 5E 14 MDM					
364455	Bancite #1	19N	20W	7SE 8SW	14	B:5415 P:210	12/25/04
363097	Golden Gate	19N	20W	20NE 20NW	14	B:5330 P:769	11/2/04
363098	Banner	19N	20W	20NE 3E SW	14	B:5330 P:771	11/2/04
364338	Mitchell #1	19N	20W	20NW	14	B:5413 P:513	1/3/05
364339	Mitchell #2	19N	20W	20NW NE	14	B:5413 P:511	1/3/05
364822	Mitchell #3	19N	20W	20NE SW 3E	14	B:5539 P:798	3/17/05
394709	Mitchell No 4	19N	20W	20NW	14	B:7320 P:786	9/2/08
394710	Mitchell No 5	19N	20W	20NW SW	14	B:7320 P:788	9/2/08
394708	Leland No 4	19N	20W	17SW 20NW	14	B:7320 P:784	9/2/08
394711	Leland No 3	19N	20W	17SW SE	14	B:7320 P:782	9/2/08

4237009

(Continued on page 2)

ENTERED
AUG 24 2018
BY: PKM

2. Type of labor and improvements (specify what was done and give the total value for that labor and improvement to show at least \$100 for each claim). If a geological, geochemical, or geophysical survey was performed, as per 30 U.S.C. 28-1, reference the title of the report of survey, give cost and date of the survey and report, and indicate it was filed with the County Recorder:

Description of Work Performed	Value of Work Performed	Date Work Was Performed
Reinstate mine sluice, Bluehour	1800.00	Oct - Jan
Repair flood damaged roads	700.00	Aug - Nov
Clear brush for fire suppression	150.00	Apr - Jun

3. Name and mailing address of each person who performed the labor and improvements:

Name (please print)

Maurzen Walsh

Current Mailing Address (please print)

1082 Moonlight Dr, Las Vegas, NV 89130

RECEIVED
 M. A. STATE DEPT.
 218 AUG 15 P 2:38
 PHOENIX, ARIZONA

4. Name and mailing address of each person who holds and claims the subject mining claim(s) for the valuable minerals contained therein. Be sure to indicate if there is a change of address:

Name (please print)

Maurzen Walsh

Current Mailing Address (please print)

1082 Moonlight Dr, Las Vegas, NV 89130

5. The undersigned testifies that on the date of August, 2018, all monuments required by law were erected upon the subject claim(s), and all notices required by law were posted on the subject claim(s) or copies thereof were in place, and at said date, each corner monument bore or contained

markings sufficient to appropriately designate the corner of the claim to which it pertains and the name of the claim(s).

I hereby certify under penalty of perjury under the laws of the State of Arizona that the foregoing statements are true and correct:

Melinda Sue Mauser
(Signature of person responsible for above statement)

Date: 8-13-18

Title 18 U.S.C. 1001 and 43 U.S.C. 1212 make it a crime for any person knowingly and willfully to make to any department or agency of the United States any false, fictitious or fraudulent statements or representations as to any matter within its jurisdiction.

Notary Block

SUBSCRIBED AND SWORN TO before me, this 13th day of August 2018

By: Melinda Sue Mauser
(Signature of Affiant)

Title: Admin. Assistant

My Commission Expires: 1-22-22

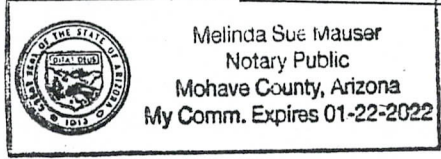
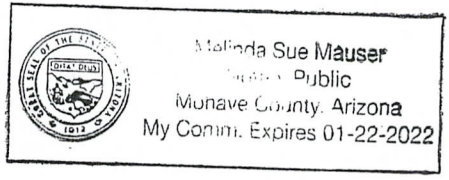

INSTRUCTIONS

1. This is an optional form that may be used to satisfy the requirements for the Bureau of Land Management (BLM) under the provisions of 43 U.S.C. §1744 and 30 U.S.C. §28-28d and the regulations thereunder (43 CFR part 3835). Since local and State laws may vary, you should contact your local and State agencies where the claims are located to ensure all applicable laws and requirements are satisfied.
2. The claimant(s) must fill in the date in paragraph 1 for the applicable assessment year and the county and state where the claims are located.
3. All claim names, BLM serial numbers, legal descriptions, and original county recording information must be listed for the claims pertaining to this assessment notice.
4. The claimant(s) must complete paragraph 2 listing all labor or improvements which was performed on or did benefit the subject mining claims. The value and date of the labor or improvements must also be listed. The total amount of labor or improvements can be listed, but the total expenditure must equal at least \$100 for each claim.
5. The names and current mailing addresses of the person(s) performing the labor shall be listed in paragraph 3.
6. The name and current mailing address of each owner (claimant) of the claims shall be listed in paragraph 4. The mailing address shall be the owner's address and not the address of an agent or anyone representing the claimant. Be sure to note if there has been a change of address.
7. Paragraph 5 shall be completed to show the date it was verified that all monuments required by law were properly erected, all notices were posted, and that corners were appropriately designated for all claims listed.
8. An exact legible reproduction or duplicate (other than microfilm or other electronic media) of this affidavit or another type of affidavit of assessment work that you file or will file in the county where each claim is located, must be filed with the BLM on or before December 30 of the calendar year in which the assessment year ends. For mill or tunnel sites, a separate notice of intent to hold must be filed with the BLM on or before December 30. Requirements for filing a notice of intent to hold can be found at 43 CFR 3835.33.
9. A processing fee of \$10 for each claim listed must be remitted to the BLM along with this and any other affidavit of assessment work.

2018 AUG 15 P 2:38
BLM FIELD OFFICE
MORRIS ARIZONA

United States Department of the Interior
Bureau of Land Management
 DIV OF LANDS, MINRLS & ENERGY
 ONE N CENTRAL AVE
 PHOENIX, AZ 85004 -4427
 Phone: 602-417-9200

Receipt

No: 4237009

Transaction #: 4352390	
Date of Transaction: 08/16/2018	
CUSTOMER:	
MAUREEN WALSH 6082 MOONLIGHT DR LAS VEGAS,NV 89130-1017 US	

LINE #	QTY	DESCRIPTION	REMARKS	UNIT PRICE	TOTAL
1	1.00	LOCATABLE MINERALS / MINING CLAIMS- NOT NEW-UNADJUD,ONE AUTH NO. ONLY / MINING CLAIM MONEY RECEIVED CASES: AMC364455/\$100.00	POL 2018/10 WAV	- n/a -	100.00
TOTAL:					\$100.00

PAYMENT INFORMATION			
1	AMOUNT:	100.00	POSTMARKED: N/A
	TYPE:	CHECK	RECEIVED: 08/15/2018
	CHECK NO:	1056	
	NAME:	WALSH, MAUREEN 6082 MOONLIGHT DR LAS VEGAS NV 89130-1017 US	

REMARKS

This receipt was generated by the automated BLM Collections and Billing System and is a paper representation of a portion of the official electronic record contained therein.

PRIORITY[®]
★ MAIL ★

FLAT RATE ENVELOPE
ONE RATE ★ ANY WEIGHT*

APPLY PRIORITY MAIL POSTAGE HERE



1006



85004

U.S. POSTAGE
PAID
LAS VEGAS, NV
89108
AUG 13, 18
AMOUNT
\$6.70
R2304W120091-82

EXPECTED DELIVERY DAY: 08/15/2018

USPS TRACKING NUMBER



9505 5100 5859 8225 2218 73

RECEIVED
BLM AZ STATE OFFICE
2018 AUG 15 P 2:37
PHOENIX, ARIZONA

UNITED STATES
DEPARTMENT OF THE INTERIOR
BUREAU OF LAND MANAGEMENT

MAINTENANCE FEE WAIVER CERTIFICATION

SEE INSTRUCTIONS ON PAGE 2

129

394708

364455
~~360~~ 363097
364338
364822

FORM APPROVED
OMB NO. 1004-0114
Expires: January 31, 2020

(RAM)

- This small miner waiver is filed for the assessment year beginning on September 1, 2017 and ending on September 1, 2018.
- The undersigned and all related parties owned ten or fewer mining claims, mill, or tunnel sites located and maintained on Federal lands in the United States of America on September 1, 2017.
- The undersigned has performed the assessment work required by law for each mining claim listed prior to filing this waiver and understand that by filing this form, the undersigned must file an affidavit of assessment work with the Bureau of Land Management (BLM) by the December 30th following the filing of this waiver.
- The undersigned understand that if the assessment work obligation has not yet come due under 30 U.S.C. 28 (for those claims in their first assessment year only), a notice of intent to hold reciting this condition must be recorded by the December 30th following the filing of this waiver.
- The undersigned understand that mill and tunnel sites may also be listed on this waiver and be waived from payment of the maintenance fee, and that a notice of intent to hold for these sites is required to be filed with the BLM by the December 30th following the filing of this waiver.
- The undersigned understand and acknowledge that pursuant to 43 U.S.C. 1212 and 18 U.S.C. 1001, the filing or recording of a false, fictitious, or fraudulent document with the BLM may result in a fine of up to \$250,000, a prison term not to exceed five years, or both.
- The mining claims, mill or tunnel sites for which this waiver from payment of the maintenance fees is requested are:

CLAIM OR SITE NAME	BLM RECORDATION SERIAL NUMBER
1. <u>Brucite #1</u>	<u>364455</u>
2. <u>Golden Gate</u>	<u>363097</u>
3. <u>Banner</u>	<u>363098</u>
4. <u>Mitchell #1</u>	<u>364338</u>
5. <u>Mitchell #2</u>	<u>364339</u>
6. <u>Mitchell #3</u>	<u>364822</u>
7. <u>Mitchell No 4</u>	<u>394709</u>
8. <u>Mitchell No 5</u>	<u>394710</u>
9. <u>Leland No 4</u>	<u>394708</u>
10. <u>Leland No 3</u>	<u>394711</u>

The owner(s) (claimants) of the above mining claims and sites are:

Maureen Walsh
(Owner's Name - Please Print)
6082 Moonlight Dr
(Owner's Mailing Address)

Maureen Walsh
(Owner's Signature)
Las Vegas NV 89130
(City) (State) (Zip Code)

(Owner's Name - Please Print)

(Owner's Signature)

(Owner's Mailing Address)

(City) (State) (Zip Code)

(Owner's Name - Please Print)

(Owner's Signature)

(Owner's Mailing Address)

(City) (State) (Zip Code)

(Owner's Name - Please Print)

(Owner's Signature)

(Owner's Mailing Address)

(City) (State) (Zip Code)

(Continued on page 2)

483

RECEIVED
BLM FIELD OFFICE
2017 AUG - 19
HOPEWELL, ARIZONA

BY: [Signature]

(Owner's Name - Please Print)	(Owner's Signature)		
(Owner's Mailing Address)	(City)	(State)	(Zip Code)
(Owner's Name - Please Print)	(Owner's Signature)		
(Owner's Mailing Address)	(City)	(State)	(Zip Code)
(Owner's Name - Please Print)	(Owner's Signature)		
(Owner's Mailing Address)	(City)	(State)	(Zip Code)
(Owner's Name - Please Print)	(Owner's Signature)		
(Owner's Mailing Address)	(City)	(State)	(Zip Code)

18 U.S.C. 1001 and 43 U.S.C. 1212 make it a crime for any person knowingly and willfully to make to any department or agency of the United States any false, fictitious or fraudulent statements or representations as to any matter within its jurisdiction.

INSTRUCTIONS

1. This certification is made under the provisions of 43 U.S.C. § 1744 and 30 U.S.C. §28-28k and the regulations thereunder (43 CFR Part 3830).
2. The claimant(s) must fill in the dates in paragraph 1 for the beginning and ending of the assessment year for which this waiver is sought.
3. The claimant(s) must fill in the date in paragraph 2 for the beginning of the assessment year for which this waiver is sought.
4. All claim and site names and BLM serial numbers must be listed for the mining claims, mill sites, and tunnel sites for which the waiver is sought.
5. All owners of the mining claims, mill sites, and tunnel sites and their addresses must be given.
6. This waiver form must be signed by all the claimants or their designated agent, in original form. If an agent is designated, a notarized designation of agent, signed by all of the claimants with proper address given, must be submitted with this waiver.
7. This form must be filed no later than September 1st for the upcoming assessment year in the BLM State Office where the mining claims or sites are recorded, or the waiver cannot be granted by the BLM. (Example: To obtain a waiver for the assessment year 2012, which begins on September 1, 2011, you must qualify for and file for a waiver no later than September 1, 2011, in the proper BLM State Office.)
8. For all mining claims which require assessment work, you must record an affidavit of labor on or before the December 30th immediately following the filing of this waiver. For all other mining claims or sites waived, you must record a notice of intent to hold on or before the December 30th immediately following the filing of this waiver.
9. Mill and tunnel sites may also be listed on this waiver and be waived from payment of the maintenance fee. A notice of intent to hold for these sites is required to be filed by the December 30th following the filing of this waiver.

FOR OFFICIAL USE ONLY

RECEIVED
2011 AUG -7 P 3:19
PHOENIX, ARIZONA



**Judicial
Watch**
*Because no one
is above the law*

Ms. Maureen Walsh
6082 Moonlight Dr.
Las Vegas, NV 89130

123591

BLM
Arizona State Office
1 North Central Ave, Ste 200
Phoenix, Az 85004

PHOENIX ARIZONA

2017 AUG -1 P 3:19

RECEIVED
BLM AZ STATE OFFICE

UNITED STATES
DEPARTMENT OF THE INTERIOR
BUREAU OF LAND MANAGEMENT

FORM APPROVED
OMB NO.: 1004-0114
Expires: October 31, 2016

AFFIDAVIT OF ANNUAL ASSESSMENT WORK

363097 364822
364338 394708
364455

FEE# 2016042869

OFFICIAL RECORDS
OF MOHAVE COUNTY
ROBERT BALLARD,
COUNTY RECORDER



09/22/2016 08:52 AM Fee: \$15.00

PAGE: 1 of 4

FOR COUNTY RECORDER'S USE

WHEN RECORDED, MAIL DOCUMENT TO:

NAME: Maureen Walsh

ADDRESS: 6082 Moonlight Dr

CITY, STATE, ZIP: Las Vegas, NV
89130

No. of Claims 10

x \$10/claim

Total due BLM \$ 100.00

TO ALL WHOM IT MAY CONCERN:

1. The undersigned certifies that at least \$100 per claim was expended for development, labor and improvements, or equivalent value added, as the annual assessment work for the assessment year ending September 1, 2016 for the following contiguous unpatented mining claim(s), located in the County of Mohave, in the State of Arizona.

BLM Serial No.	Name of Claim	Tp	Rg	Sec	Mer	County Recordation Book and Page No.	Date
364455	Brucite #1	1911	20W	25E 25SW	14	B: 5415 P: 210	12/25/04
363097	Golden Gate	1911	20W	20NE 20NW	14	B: 5330 P: 769	11/2/04
363098	Banner	1911	20W	20NE 20SE	14	B: 5330 P: 771	11/2/04
364338	Mitchell #1	1911	20W	20NW	14	B: 5413 P: 513	1/3/05
364339	Mitchell #2	1911	20W	20NE 20SE	14	B: 5413 P: 511	1/3/05
364822	Mitchell #3	1911	20W	20NE 20SE	14	B: 5539 P: 798	1/17/05
394709	Mitchell No 4	1911	20W	20NW	14	B: 7320 P: 786	9/2/08
394710	Mitchell No 5	1911	20W	20NW 20SW	14	B: 7320 P: 788	9/2/08
394708	Leland No 4	1911	20W	17SW 20NW	14	B: 7320 P: 784	9/2/08
394711	Leland No 3	1911	20W	17SW 20SE	14	B: 7320 P: 783	9/2/08

(Continued on page 2)

RECEIPT # 3670974

2. Type of labor and improvements (specify what was done and give the total value for that labor and improvement to show at least \$100 for each claim). If a geological, geochemical, or geophysical survey was performed, as per 30 U.S.C. 28-1, reference the title of the report of survey, give cost and date of the survey and report, and indicate it was filed with the County Recorder:

Description of Work Performed	Value of Work Performed	Date Work Was Performed
Recirculate mini sluice Bluebowl	1900.00	Oct-May
Repair flood damaged roads	300.00	Oct-May
Clear brush for fire suppression	150.00	Apr-May

3. Name and mailing address of each person who performed the labor and improvements:

Name (please print) Maurice Walsh Current Mailing Address (please print) 6082 Moonlight Dr, Las Vegas, NV 89130

4. Name and mailing address of each person who holds and claims the subject mining claim(s) for the valuable minerals contained therein. Be sure to indicate if there is a change of address:

Name (please print) Maurice Walsh Current Mailing Address (please print) 6082 Moonlight Dr, Las Vegas, NV 89130

RECEIVED
 BLM AZ STATE OFFICE
 PHOENIX, ARIZONA
 2018 SEP 30 P 2:55

5. The undersigned testifies that on the date of August, 2018, all monuments required by law were erected upon the subject claim(s), and all notices required by law were posted on the subject claim(s) or copies thereof were in place, and at said date, each corner monument bore or contained

markings sufficient to appropriately designate the corner of the claim to which it pertains and the name of the claim(s).

I hereby certify under penalty of perjury under the laws of the State of Arizona that the foregoing statements are true and correct:

Noreen Murphy
(Signature of person responsible for above statement)

Date: 9-22-2016

Title 18 U.S.C. 1001 and 43 U.S.C. 1212 make it a crime for any person knowingly and willfully to make to any department or agency of the United States any false, fictitious or fraudulent statements or representations as to any matter within its jurisdiction.

Notary Block

SUBSCRIBED AND SWORN TO before me, this 22nd day of September 2016

By: Noreen Murphy
(Signature of Affiant)

Title: Notary Public

My Commission Expires: April 20, 2017

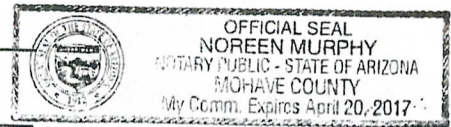

INSTRUCTIONS

1. This is an optional form that may be used to satisfy the requirements for the Bureau of Land Management (BLM) under the provisions of 43 U.S.C. §1744 and 30 U.S.C. §28-28d and the regulations thereunder (43 CFR part 3835). Since local and State laws may vary, you should contact your local and State agencies where the claims are located to ensure all applicable laws and requirements are satisfied.
2. The claimant(s) must fill in the date in paragraph 1 for the applicable assessment year and the county and state where the claims are located.
3. All claim names, BLM serial numbers, legal descriptions, and original county recording information must be listed for the claims pertaining to this assessment notice.
4. The claimant(s) must complete paragraph 2 listing all labor or improvements which was performed on or did benefit the subject mining claims. The value and date of the labor or improvements must also be listed. The total amount of labor or improvements can be listed, but the total expenditure must equal at least \$100 for each claim.
5. The names and current mailing addresses of the person(s) performing the labor shall be listed in paragraph 3.
6. The name and current mailing address of each owner (claimant) of the claims shall be listed in paragraph 4. The mailing address shall be the owner's address and not the address of an agent or anyone representing the claimant. Be sure to note if there has been a change of address.
7. Paragraph 5 shall be completed to show the date it was verified that all monuments required by law were properly erected, all notices were posted, and that corners were appropriately designated for all claims listed.
8. An exact legible reproduction or duplicate (other than microfilm or other electronic media) of this affidavit or another type of affidavit of assessment work that you file or will file in the county where each claim is located, must be filed with the BLM on or before December 30 of the calendar year in which the assessment year ends. For mill or tunnel sites, a separate notice of intent to hold must be filed with the BLM on or before December 30. Requirements for filing a notice of intent to hold can be found at 43 CFR 3835.33.
9. A processing fee of \$10 for each claim listed must be remitted to the BLM along with this or any other affidavit of assessment work.

NOTICES

THE PRIVACY ACT and 43 CFR 2.48(d) require that you be furnished with the following information in connection with the information requested by this form.

AUTHORITY: 30 U.S.C. §28-28d and 43 CFR part 3835 permit collection of the information requested by this form.

PRINCIPAL PURPOSE: The BLM will use the information you provide to document compliance with 43 U.S.C. 1744 and that assessment work has been completed in accordance with 30 U.S.C. § 28-28d and 43 CFR part 3835 in lieu of paying the maintenance fee for the mining claims listed on this form.

ROUTINE USES: The BLM will only disclose this information in accordance with the provisions at 43 CFR 2.56(b) and (c).

EFFECT OF NOT PROVIDING INFORMATION: Disclosure of the requested information is required by 30 U.S.C. § 28-28d and 43 CFR part 3835 for claimants qualified to perform assessment work in lieu of paying the maintenance fee. Failure to submit all the requested information or to complete this form will delay the BLM's processing of the form and may preclude the BLM's acceptance of the assessment work information, which may result in forfeiture of the mining claim(s) by the claimant.

THE PAPERWORK REDUCTION ACT requires us to inform you that:

Use of this form is optional. You must perform assessment if a waiver to pay the maintenance fee has been requested. This form is provided to help you attest that annual assessment work has been completed in lieu of paying the maintenance fee for your claim(s). Submission of the requested information is necessary to obtain or retain a benefit.

You do not have to respond to this or any other Federal agency-sponsored information collection unless it displays a valid OMB control number.

BURDEN HOURS STATEMENT: The estimated public reporting burden for this form is 30 minutes per response, including the time for reviewing instructions, gathering and maintaining data, and completing and reviewing the form. You may submit comments regarding the burden estimate or any other aspect of this form to: U.S. Department of the Interior, Bureau of Land Management (1004-0114), Bureau Information Collection Clearance Officer (WO-630), 1849 C Street, N.W., Room 2134LM, Washington, D.C. 20240.

RECEIVED
BLM AZ STATE OFFICE
2016 SEP 30 P 2:55
PHOENIX, ARIZONA

United States Department of the Interior
Bureau of Land Management
 DIV OF LANDS, MINRLS & ENERGY
 ONE N CENTRAL AVE
 PHOENIX, AZ 85004 -4427
 Phone: 602-417-9200

Receipt

No: 3670974

Transaction #: 3775258	
Date of Transaction: 10/03/2016	
CUSTOMER:	
MAUREEN WALSH 6082 MOONLIGHT DR LAS VEGAS,NV 89130-1017 US	

LINE #	QTY	DESCRIPTION	REMARKS	UNIT PRICE	TOTAL
1	1.00	LOCATABLE MINERALS / MINING CLAIMS- NOT NEW-UNADJUD,ONE AUTH NO. ONLY / MINING CLAIM MONEY RECEIVED CASES: AMC364455/\$100.00	POL (10) 2016	- n/a -	100.00
TOTAL:					\$100.00

PAYMENT INFORMATION					
1	AMOUNT:	100.00	POSTMARKED:	09/28/2016	
	TYPE:	CHECK	RECEIVED:	09/30/2016	
	CHECK NO:	0649			
	NAME:	WALSH, MAUREEN 6082 MOONLIGHT DR LAS VEGAS NV 89130-1017 US			

REMARKS

This receipt was generated by the automated BLM Collections and Billing System and is a paper representation of a portion of the official electronic record contained therein.

ENTERED
 OCT - 4 2016
 BY: *[Signature]*



Ms. Maureen Walsh
6082 Moonlight Dr.
Las Vegas, NV 89130-1017

RECEIVED
BLM AZ STATE OFFICE
2016 SEP 30 P 2:54

PHOENIX, ARIZONA

BLM
Arizona State Office
One North Central Ave, Ste 800
Phoenix, AZ 85004

PRIORITY®
★ MAIL ★

FLAT RATE ENVELOPE
ONE RATE ★ ANY WEIGHT*

APPLY PRIORITY MAIL POSTAGE HERE

P

US POSTAGE
mPOS

062S0009166055
FROM 89130



\$6.45

0024
09/28/2016

PRIORITY MAIL 2-DAY™

USPS TRACKING #

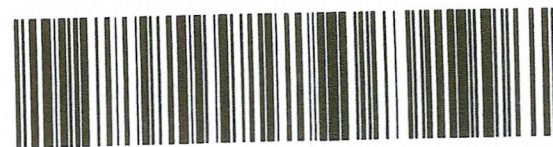

9405 5118 9956 3673 1260 84

* For International shipments, the maximum weight is 4 lbs.

EP14H July 2013 Outer Dimension: 10 x 5

PRIORITY[®]
★ MAIL ★

FLAT RATE ENVELOPE
ONE RATE ★ ANY WEIGHT*

RECEIVED
BLM AZ STATE OFFICE

2016 SEP 30 P 2:54

PHOENIX, ARIZONA

PRESS FIRMLY TO SEAL



* Domestic only.

PRESS FIRMLY TO SEAL

PRIORITY[®]
★ MAIL ★

 DATE OF DELIVERY SPECIFIED*

 USPS TRACKING[™] INCLUDED*

 INSURANCE INCLUDED*

 PICKUP AVAILABLE

* Domestic only

VISIT US AT USPS.COM[®]
ORDER FREE SUPPLIES ONLINE



EP14H July 2013
OD: 10 x 5

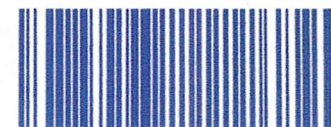

PS00001000064

EP14H © U.S. Postal Service, July 2013. All rights reserved.

This packaging is the property of the U.S. Postal Service[®] and is provided solely for use in sending Priority Mail[®] shipments. Misuse may be a violation of federal law. This packaging is not for resale.

UNITED STATES
DEPARTMENT OF THE INTERIOR
BUREAU OF LAND MANAGEMENT
MAINTENANCE FEE WAIVER CERTIFICATION

130
Ram

364822
394708
364455
363097
364338

FORM APPROVED
OMB NO. 1004-0114
Expires: October 31, 2016

SEE INSTRUCTIONS ON PAGE 2

- This small miner waiver is filed for the assessment year beginning on September 1, 2016 and ending on September 1, 2017.
- The undersigned and all related parties owned ten or fewer mining claims, mill, or tunnel sites located and maintained on Federal lands in the United States of America on September 1, 2016.
- The undersigned have performed the assessment work required by law for each mining claim listed prior to filing this waiver and understand that by filing this form, the undersigned must file an affidavit of assessment work with the Bureau of Land Management (BLM) by the December 30th following the filing of this waiver.
- The undersigned understand that if the assessment work obligation has not yet come due under 30 U.S.C. 28 (for those claims in their first assessment year only), a notice of intent to hold reciting this condition must be recorded by the December 30th following the filing of this waiver.
- The undersigned understand that mill and tunnel sites may also be listed on this waiver and be waived from payment of the maintenance fee, and that a notice of intent to hold for these sites is required to be filed with the BLM by the December 30th following the filing of this waiver.
- The undersigned understand and acknowledge that pursuant to 43 U.S.C. 1212 and 18 U.S.C. 1001, the filing or recording of a false, fictitious, or fraudulent document with the BLM may result in a fine of up to \$250,000, a prison term not to exceed five years, or both.
- The mining claims, mill or tunnel sites for which this waiver from payment of the maintenance fees is requested are:

CLAIM OR SITE NAME	BLM RECORDATION SERIAL NUMBER
1. Brucite #1	364455
2. Golden Gate	363097
3. Banner	363098
4. Mitchell #1	364338
5. Mitchell #2	364339
6. Mitchell #3	364822
7. Mitchell No 4	394709
8. Mitchell No 5	394710
9. Leland No 4	394708
10. Leland No 3	394711

The owner(s) (claimants) of the above mining claims and sites are:

Maureen Walsh
(Owner's Name - Please Print)
6082 Moonlight Dr
(Owner's Mailing Address)

Maureen Walsh
(Owner's Signature)
Las Vegas NV 89130
(City) (State) (Zip Code)

(Owner's Name - Please Print)

(Owner's Mailing Address)

(Owner's Signature)

(City) (State) (Zip Code)

(Owner's Name - Please Print)

(Owner's Mailing Address)

(Owner's Signature)

(City) (State) (Zip Code)

(Owner's Name - Please Print)

(Owner's Mailing Address)

(Owner's Signature)

(City) (State) (Zip Code)

(Continued on page 2)

ENTERED
AUG 31 2016
BY: RE

NL
8-31
RE

RECEIVED
BUREAU OF LAND MANAGEMENT
PHOENIX, ARIZONA
JUL 27 3:26 PM

(Owner's Name - Please Print)

(Owner's Signature)

(Owner's Mailing Address)

(City)

(State)

(Zip Code)

(Owner's Name - Please Print)

(Owner's Signature)

(Owner's Mailing Address)

(City)

(State)

(Zip Code)

(Owner's Name - Please Print)

(Owner's Signature)

(Owner's Mailing Address)

(City)

(State)

(Zip Code)

(Owner's Name - Please Print)

(Owner's Signature)

(Owner's Mailing Address)

(City)

(State)

(Zip Code)

18 U.S.C. 1001 and 43 U.S.C. 1212 make it a crime for any person knowingly and willfully to make to any department or agency of the United States any false, fictitious or fraudulent statements or representations as to any matter within its jurisdiction.

INSTRUCTIONS

1. This certification is made under the provisions of 43 U.S.C. § 1744 and 30 U.S.C. §28-28k and the regulations thereunder (43 CFR Part 3830).
2. The claimant(s) must fill in the dates in paragraph 1 for the beginning and ending of the assessment year for which this waiver is sought.
3. The claimant(s) must fill in the date in paragraph 2 for the beginning of the assessment year for which this waiver is sought.
4. All claim and site names and BLM serial numbers must be listed for the mining claims, mill sites, and tunnel sites for which the waiver is sought.
5. All owners of the mining claims, mill sites, and tunnel sites and their addresses must be given.
6. This waiver form must be signed by all the claimants or their designated agent, in original form. If an agent is designated, a notarized designation of agent, signed by all of the claimants with proper address given, must be submitted with this waiver.
7. This form must be filed no later than September 1st for the upcoming assessment year in the BLM State Office where the mining claims or sites are recorded, or the waiver cannot be granted by the BLM. (Example: To obtain a waiver for the assessment year 2012, which begins on September 1, 2011, you must qualify for and file for a waiver no later than September 1, 2011, in the proper BLM State Office.)
8. For all mining claims which require assessment work, you must record an affidavit of labor on or before the December 30th immediately following the filing of this waiver. For all other mining claims or sites waived, you must record a notice of intent to hold on or before the December 30th immediately following the filing of this waiver.
9. Mill and tunnel sites may also be listed on this waiver and be waived from payment of the maintenance fee. A notice of intent to hold for these sites is required to be filed by the December 30th following the filing of this waiver.

FOR OFFICIAL USE ONLY

394708 364455
363097

AFFIDAVIT OF ANNUAL ASSESSMENT WORK

WHEN RECORDED, MAIL DOCUMENT TO:

NAME: Maurice Walsh
ADDRESS: 6082 Moonlight Dr
CITY, STATE, ZIP: Las Vegas, NV 89130

FEE# 2015053166

OFFICIAL RECORDS
OF MOHAVE COUNTY
CAROL MEIER,
COUNTY RECORDER



364338
364822

12/02/2015 01:40 PM Fee: \$15.00

PAGE: 1 of 4

FOR COUNTY RECORDER'S USE

No. of Claims 10
x \$10/claim
Total due BLM \$ 100.00

TO ALL WHOM IT MAY CONCERN:

1. The undersigned certifies that at least \$100 per claim was expended for development, labor and improvements, or equivalent value added, as the annual assessment work for the assessment year ending September 1, 2015 for the following contiguous unpatented mining claim(s), located in the County of Mohave, in the State of Arizona.

BLM Serial No.	Name of Claim	Tp	Rg	Sec	Mer	County Recordation Book and Page No.	Date
364455	Brucite #1	19N	20W	75E 85W	14	B: 5415 P: 210	12-25-04
363097	Golden Gate	19N	20W	20NE 20NW	14	B: 5330 P: 769	11-2-04
363098	Banner	19N	20W	20NE 85W	14	B: 5330 P: 771	11-2-04
364338	Mitchell #1	19N	20W	20NW	14	B: 5413 P: 513	1-3-05
364339	Mitchell #2	19N	20W	20NW NE	14	B: 5413 P: 511	1-3-05
364822	Mitchell #3	19N	20W	20NE SW SE	14	B: 5539 P: 798	3-17-05
394709	Mitchell No 4	19N	20W	20NW	14	B: 7320 P: 786	9-2-08
394710	Mitchell No 5	19N	20W	20NW SW	14	B: 7320 P: 788	9-2-08
394708	Leland No 4	19N	20W	17SW 20NW	14	B: 7320 P: 784	9-2-08
394711	Leland No 3	19N	20W	17SW SE	14	B: 7320 P: 782	9-2-08

RECEIVED
BY MAIL OFFICE
PHOENIX, ARIZONA
DEC - 7 P 3:02

(Continued on page 2)

RECEIPT # 3449752

2. Type of labor and improvements (specify what was done and give the total value for that labor and improvement to show at least \$100 for each claim). If a geological, geochemical, or geophysical survey was performed, as per 30 U.S.C. 28-1, reference the title of the report of survey, give cost and date of the survey and report, and indicate it was filed with the County Recorder:

Description of Work Performed	Value of Work Performed	Date Work Was Performed
Recirculate mini sluice	1400.00	Oct 2014 - May 2015
Repair damaged roads	800.00	Oct + Nov 2014
Clearing brush	400.00	Oct 2014 + May 2015

3. Name and mailing address of each person who performed the labor and improvements:

Name (please print)

Maurcen Walsh

Current Mailing Address (please print)

6082 Moonlight Dr, Las Vegas, NV 89130

4. Name and mailing address of each person who holds and claims the subject mining claim(s) for the valuable minerals contained therein. Be sure to indicate if there is a change of address:

Name (please print)

Maurcen Walsh

Current Mailing Address (please print)

6082 Moonlight Dr, Las Vegas, NV 89130

RECEIVED
 DLM AUSTIN OFFICE
 2015 DEC -7 P 3:02
 PHOENIX, ARIZONA

5. The undersigned testifies that on the date of December 2, 2015, all monuments required by law were erected upon the subject claim(s), and all notices required by law were posted on the subject claim(s) or copies thereof were in place, and at said date, each corner monument bore or contained

markings sufficient to appropriately designate the corner of the claim to which it pertains and the name of the claim(s).

I hereby certify under penalty of perjury under the laws of the State of Arizona that the foregoing statements are true and correct:

Maureen Walsh Date: December 2, 2015
(Signature of person responsible for above statement)

Title 18 U.S.C. 1001 and 43 U.S.C. 1212 make it a crime for any person knowingly and willfully to make to any department or agency of the United States any false, fictitious or fraudulent statements or representations as to any matter within its jurisdiction.

Notary Block

SUBSCRIBED AND SWORN TO before me, this 2nd day of January 2015

By: Maureen Walsh
(Signature of Affiant)

Title: City Clerk Sydney Muhle

My Commission Expires: October 17, 2016

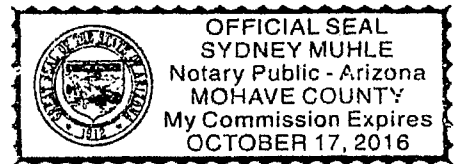

INSTRUCTIONS

1. This is an optional form that may be used to satisfy the requirements for the Bureau of Land Management (BLM) under the provisions of 43 U.S.C. §1744 and 30 U.S.C. §28-28d and the regulations thereunder (43 CFR part 3835). Since local and State laws may vary, you should contact your local and State agencies where the claims are located to ensure all applicable laws and requirements are satisfied.
2. The claimant(s) must fill in the date in paragraph 1 for the applicable assessment year and the county and state where the claims are located.
3. All claim names, BLM serial numbers, legal descriptions, and original county recording information must be listed for the claims pertaining to this assessment notice.
4. The claimant(s) must complete paragraph 2 listing all labor or improvements which was performed on or did benefit the subject mining claims. The value and date of the labor or improvements must also be listed. The total amount of labor or improvements can be listed, but the total expenditure must equal at least \$100 for each claim.
5. The names and current mailing addresses of the person(s) performing the labor shall be listed in paragraph 3.
6. The name and current mailing address of each owner (claimant) of the claims shall be listed in paragraph 4. The mailing address shall be the owner's address and not the address of an agent or anyone representing the claimant. Be sure to note if there has been a change of address.
7. Paragraph 5 shall be completed to show the date it was verified that all monuments required by law were properly erected, all notices were posted, and that corners were appropriately designated for all claims listed.
8. An exact legible reproduction or duplicate (other than microfilm or other electronic media) of this affidavit or another type of affidavit of assessment work that you file or will file in the county where each claim is located, must be filed with the BLM on or before December 30 of the calendar year in which the assessment year ends. For mill or tunnel sites, a separate notice of intent to hold must be filed with the BLM on or before December 30. Requirements for filing a notice of intent to hold can be found at 43 CFR 3835.33.
9. A processing fee of \$10 for each claim listed must be remitted to the BLM along with this or any other affidavit of assessment work.

RECEIVED
BLM
MORRISON
D-3-02

NOTICES

THE PRIVACY ACT and 43 CFR 2.48(d) require that you be furnished with the following information in connection with the information requested by this form.

AUTHORITY: 30 U.S.C. §28-28d and 43 CFR part 3835 permit collection of the information requested by this form.

PRINCIPAL PURPOSE: The BLM will use the information you provide to document compliance with 43 U.S.C. 1744 and that assessment work has been completed in accordance with 30 U.S.C. § 28-28d and 43 CFR part 3835 in lieu of paying the maintenance fee for the mining claims listed on this form.

ROUTINE USES: The BLM will only disclose this information in accordance with the provisions at 43 CFR 2.56(b) and (c).

EFFECT OF NOT PROVIDING INFORMATION: Disclosure of the requested information is required by 30 U.S.C. § 28-28d and 43 CFR part 3835 for claimants qualified to perform assessment work in lieu of paying the maintenance fee. Failure to submit all the requested information or to complete this form will delay the BLM's processing of the form and may preclude the BLM's acceptance of the assessment work information, which may result in forfeiture of the mining claim(s) by the claimant.

THE PAPERWORK REDUCTION ACT requires us to inform you that:

Use of this form is optional. You must perform assessment if a waiver to pay the maintenance fee has been requested. This form is provided to help you attest that annual assessment work has been completed in lieu of paying the maintenance fee for your claim(s). Submission of the requested information is necessary to obtain or retain a benefit.

You do not have to respond to this or any other Federal agency-sponsored information collection unless it displays a valid OMB control number.

BURDEN HOURS STATEMENT: The estimated public reporting burden for this form is 30 minutes per response, including the time for reviewing instructions, gathering and maintaining data, and completing and reviewing the form. You may submit comments regarding the burden estimate or any other aspect of this form to: U.S. Department of the Interior, Bureau of Land Management (1004-0114), Bureau Information Collection Clearance Officer (WO-630), 1849 C Street, N.W., Room 2134LM, Washington, D.C. 20240.

RECEIVED
BLM AT STANBEE OFFICE
2015 DEC - 7 P 3:02
PHOENIX, ARIZONA



**PRIORITY
MAIL**

UNITED STATES POSTAL SERVICE

Apply Priority Mail Postage Here

Mr. Walsh
6082 Meadlight Dr
Las Vegas, NV 89130

2015 DEC -7 P 3 00

PHOENIX, ARIZONA

BLM
Arizona State Office
1 North Central Ave
Suite 800
Phoenix Az 85004

United States Department of the Interior
Bureau of Land Management
 LANDS/RECREATION & PLANNING
 ONE N CENTRAL AVE
 PHOENIX, AZ 85004 -2203
 Phone: 602-417-9200

Receipt

No: 3449752

Transaction #: 3549239	
Date of Transaction: 12/08/2015	
CUSTOMER:	
MAUREEN WALSH 6082 MOONLIGHT DR LAS VEGAS, NV 89130-1017 US	

LINE #	QTY	DESCRIPTION	REMARKS	UNIT PRICE	TOTAL
1	1.00	LOCATABLE MINERALS / MINING CLAIMS- NOT NEW-UNADJUD, ONE AUTH NO. ONLY / MINING CLAIM MONEY RECEIVED CASES: AMC364455/\$100.00	POL - 10 2015	- n/a -	100.00
TOTAL:					\$100.00

PAYMENT INFORMATION					
1	AMOUNT:	100.00	POSTMARKED:	12/03/2015	
	TYPE:	CHECK	RECEIVED:	12/07/2015	
	CHECK NO:	0482			
	NAME:	WALSH, MAUREEN 6082 MOONLIGHT DR LAS VEGAS NV 89130-1017 US			

REMARKS

This receipt was generated by the automated BLM Collections and Billing System and is a paper representation of a portion of the official electronic record contained therein.

UNITED STATES
DEPARTMENT OF THE INTERIOR
BUREAU OF LAND MANAGEMENT

130

RAM

394708 364455
363097
~~364338~~
FORM APPROVED
OMB NO. 1004-0114
Expires: October 31, 2016
364338

MAINTENANCE FEE WAIVER CERTIFICATION

SEE INSTRUCTIONS ON PAGE 2

- This small miner waiver is filed for the assessment year beginning on September 1, 2015 and ending on September 1, 2016. 364822
- The undersigned and all related parties owned ten or fewer mining claims, mill, or tunnel sites located and maintained on Federal lands in the United States of America on September 1, 2015.
- The undersigned have performed the assessment work required by law for each mining claim listed prior to filing this waiver and understand that by filing this form, the undersigned must file an affidavit of assessment work with the Bureau of Land Management (BLM) by the December 30th following the filing of this waiver.
- The undersigned understand that if the assessment work obligation has not yet come due under 30 U.S.C. 28 (for those claims in their first assessment year only), a notice of intent to hold reciting this condition must be recorded by the December 30th following the filing of this waiver.
- The undersigned understand that mill and tunnel sites may also be listed on this waiver and be waived from payment of the maintenance fee, and that a notice of intent to hold for these sites is required to be filed with the BLM by the December 30th following the filing of this waiver.
- The undersigned understand and acknowledge that pursuant to 43 U.S.C. 1212 and 18 U.S.C. 1001, the filing or recording of a false, fictitious, or fraudulent document with the BLM may result in a fine of up to \$250,000, a prison term not to exceed five years, or both.
- The mining claims, mill or tunnel sites for which this waiver from payment of the maintenance fees is requested are:

CLAIM OR SITE NAME	BLM RECORDATION SERIAL NUMBER
1. Brucite #1 ✓	364455
2. Golden Gate	363097
3. Banner	363098
4. Mitchell #1	364338
5. Mitchell #2	364339
6. Mitchell #3	364822
7. Mitchell No 4	394709
8. Mitchell No 5	394710
9. Leland No 4	394708
10. Leland No 3	394711

The owner(s) (claimants) of the above mining claims and sites are:

Maureen Walsh
(Owner's Name - Please Print)
6082 Moonlight Dr
(Owner's Mailing Address)

Maureen Walsh
(Owner's Signature)
Las Vegas NV 89130
(City) (State) (Zip Code)

(Owner's Name - Please Print)

(Owner's Signature)

(Owner's Mailing Address)

(City) (State) (Zip Code)

(Owner's Name - Please Print)

(Owner's Signature)

(Owner's Mailing Address)

(City) (State) (Zip Code)

(Owner's Name - Please Print)

(Owner's Signature)

(Owner's Mailing Address)

(City) (State) (Zip Code)

(Continued on page 2)

ENTERED
SEP 2 2015
BY: RE

RECEIVED
BLM AZ STATE OFFICE
2015 JUL 29 P 3:31
PHOENIX, ARIZONA

NW-RS 9/13

(Owner's Name - Please Print)	(Owner's Signature)		
(Owner's Mailing Address)	(City)	(State)	(Zip Code)
(Owner's Name - Please Print)	(Owner's Signature)		
(Owner's Mailing Address)	(City)	(State)	(Zip Code)
(Owner's Name - Please Print)	(Owner's Signature)		
(Owner's Mailing Address)	(City)	(State)	(Zip Code)
(Owner's Name - Please Print)	(Owner's Signature)		
(Owner's Mailing Address)	(City)	(State)	(Zip Code)

18 U.S.C. 1001 and 43 U.S.C. 1212 make it a crime for any person knowingly and willfully to make to any department or agency of the United States any false, fictitious or fraudulent statements or representations as to any matter within its jurisdiction.

INSTRUCTIONS

1. This certification is made under the provisions of 43 U.S.C. § 1744 and 30 U.S.C. §28-28k and the regulations thereunder (43 CFR Part 3830).
2. The claimant(s) must fill in the dates in paragraph 1 for the beginning and ending of the assessment year for which this waiver is sought.
3. The claimant(s) must fill in the date in paragraph 2 for the beginning of the assessment year for which this waiver is sought.
4. All claim and site names and BLM serial numbers must be listed for the mining claims, mill sites, and tunnel sites for which the waiver is sought.
5. All owners of the mining claims, mill sites, and tunnel sites and their addresses must be given.
6. This waiver form must be signed by all the claimants or their designated agent, in original form. If an agent is designated, a notarized designation of agent, signed by all of the claimants with proper address given, must be submitted with this waiver.
7. This form must be filed no later than September 1st for the upcoming assessment year in the BLM State Office where the mining claims or sites are recorded, or the waiver cannot be granted by the BLM. (Example: To obtain a waiver for the assessment year 2012, which begins on September 1, 2011, you must qualify for and file for a waiver no later than September 1, 2011, in the proper BLM State Office.)
8. For all mining claims which require assessment work, you must record an affidavit of labor on or before the December 30th immediately following the filing of this waiver. For all other mining claims or sites waived, you must record a notice of intent to hold on or before the December 30th immediately following the filing of this waiver.
9. Mill and tunnel sites may also be listed on this waiver and be waived from payment of the maintenance fee. A notice of intent to hold for these sites is required to be filed by the December 30th following the filing of this waiver.

RECEIVED
 BLM AZ STATE OFFICE
 2015 JUL 29 P 3:31
 PHOENIX, ARIZONA

FOR OFFICIAL USE ONLY

Y

364455
363097
364338
364822
394708

When Recorded Return Document to:

Maureen Walsh
6082 Moonlight Dr
Las Vegas, NV 89130

Check Here is this is a change of address.

Telephone: 702-645-3172

E-mail address: maewalsh@earthlink.net

FEE# 2014051823

OFFICIAL RECORDS
OF MOHAVE COUNTY
CAROL MEIER,
COUNTY RECORDER



12/02/2014 08:24 AM Fee: \$15.00

PAGE: 1 of 2

AFFIDAVIT OF PERFORMANCE OF ANNUAL WORK

1. State of Arizona, County of Mohave ss:
 2. I (Name) Maureen Walsh
 3. Reside at (Address) 6082 Moonlight Dr
 City Las Vegas County Clark

BLM
Date
Stamp

RECEIVED
BLM PHOENIX OFFICE
2014 DEC -4 P 3:28
PHOENIX, ARIZONA

State NV Zip 89130 being duly sworn, depose and say that I am a citizen of the United States, more than eighteen years of age, and that all of the facts set forth in this affidavit, subject to the provisions and penalties of 18 U.S.C. 1001 pertaining to the filing of false, fictitious, or fraudulent statements with the United States, are true and correct according to the best of my knowledge, information and belief.

4. Owner's name and address (If not shown in Items 1-3 above). _____

5. That I am personally acquainted with the mining claim(s). The work and improvements were made by and at the expense of the owner(s) of said claim(s). Said contiguous group of claims, listed on this document, are situated in the San Francisco (optional) Mining District; Mohave County, Arizona.

Line No.	AMC NUMBER	CLAIM/SITE NAME	COUNTY RECORDER DATA (If available)	TWP	RNG	SEC
1	364455	Brucite #1	B:5415 P:210	19N	20W	7SE 8SW
2	363097	Golden Gate	B:5330 P:769	19N	20W	20NE 20NW
3	363098	Banner	B:5330 P:771	19N	20W	20NE 20SE
4	364338	Mitchell #1	B:5413 P:513	19N	20W	20NW
5	364339	Mitchell #2	B:5413 P:511	19N	20W	20NW 20NE
6	364822	Mitchell #3	B:5539 P:798	19N	20W	20NE 20SE

Form: MCF108
Revised July 2014
Page 1 of 2

ENTERED
DEC 08 2014
BY: RAM

AFFIDAVIT OF PERFORMANCE OF ANNUAL WORK – page 2

BLM
Date
Stamp

7	394709	Mitchell No 4	B: 7320 P: 786	19 N	20 W	20 NW
8	394710	Mitchell No 5	B: 7320 P: 788	19 N	20 W	20 NW SW
9	394708	Leland No 4	B: 7320 P: 784	19 N	20 W	17 SW 20 NW
10	394711	Leland No 3	B: 7320 P: 782	19 N	20 W	17 SW SE

6. That between the dates starting at 12 o'clock noon on September 1, 20 13 and ending at 12 o'clock noon on September 1, 20 14 at least \$ 2300.00 dollars worth of work and improvements were done and performed upon said claim(s) or upon one or more of a contiguous group of claims for the benefit of all, wholly or partly outside of a contiguous group of claims for the benefit of all, not including the location work.

7. That the following persons were employed to perform the work and improvements described herein: _____

8. That the work and improvements performed were: Repair flood damaged roads, drywashing, brush removal

9. Dated: 12/2/14 Signature: Maureen Walsh

SUBSCRIBED AND SWORN TO before me, a Notary Public, this 2nd day of December 20 14

By: Maureen E. Walsh

Notary Public [Signature]

My Commission Expires Oct. 17, 2016

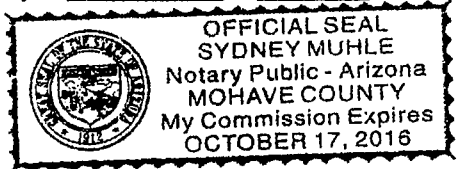

Bureau of Land Management
Arizona State Office
www.blm.gov/az

No. of Claims: 10 x \$10 = \$100.00
 Check No.: 0280 Init. [Signature]
 Receipt No.: 3183911
 For BLM Use Only

PRIORITY®
★ MAIL ★

FLAT RATE ENVELOPE
ONE RATE ★ ANY WEIGHT*

PRESS FIRMLY TO SEAL



* Domestic only.

PRESS FIRMLY TO SEAL

PRIORITY®
★ MAIL ★

 DATE OF DELIVERY SPECIFIED*

 USPS TRACKING™ INCLUDED*

 INSURANCE INCLUDED*

 PICKUP AVAILABLE

* Domestic only

PHOENIX, ARIZONA

2014 DEC -4 P 3: 28

DLM AZ STATE OFFICE

RECEIVED
VISIT US AT USPS.COM®
ORDER FREE SUPPLIES ONLINE



EP14H July 2013
OD: 10 x 5

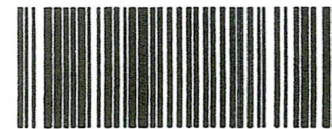

This packaging is the property of the U.S. Postal Service® and is provided solely for use in sending Priority Mail® shipments. Misuse may be a violation of federal law. This packaging is not for resale.

M. Walsh
6082 Moonlight Dr
Las Vegas, NV 89130

BLM, Arizona State Office
1 North Central Ave, Suite 800
Phoenix, AZ 85004

United States Department of the Interior
Bureau of Land Management
 LANDS/RECREATION & PLANNING
 ONE N CENTRAL AVE
 PHOENIX, AZ 85004 -2203
 Phone: 602-417-9200

Receipt

No: 3183911

Transaction #: 3276970	
Date of Transaction: 12/05/2014	
CUSTOMER:	
MAUREEN WALSH 6082 MOONLIGHT DR LAS VEGAS,NV 89130-1017 US	

LINE #	QTY	DESCRIPTION	REMARKS	UNIT PRICE	TOTAL
1	1.00	LOCATABLE MINERALS / MINING CLAIMS- NOT NEW-UNADJUD,ONE AUTH NO. ONLY / MINING CLAIM MONEY RECEIVED CASES: AMC364455/\$100.00	POL (10) 2014	- n/a -	100.00
TOTAL:					\$100.00

PAYMENT INFORMATION			
1	AMOUNT:	100.00	POSTMARKED: N/A
	TYPE:	CHECK	RECEIVED: 12/04/2014
	CHECK NO:	0280	
	NAME:	WALSH, MAUREEN 6082 MOONLIGHT DR LAS VEGAS NV 89130-1017 US	

REMARKS

This receipt was generated by the automated BLM Collections and Billing System and is a paper representation of a portion of the official electronic record contained therein.

ENTERED
DEC 08 2014
BY: *RAM*

AML 364455
363097
364338
364822
394708

UNITED STATES 265
DEPARTMENT OF THE INTERIOR
BUREAU OF LAND MANAGEMENT

Form 3830-2
(September 2010)

MAINTENANCE FEE WAIVER CERTIFICATION

W

FORM APPROVED
OMB NO. 1004-0114
Expires: August 31, 2013

SEE INSTRUCTIONS ON PAGE 2

1. This small miner waiver is filed for the assessment year beginning on September 1, 2014 and ending on September 1, 2015.
2. The undersigned and all related parties owned ten or fewer mining claims, mill, or tunnel sites located and maintained on Federal lands in the United States of America on September 1, 2014.
3. The undersigned have performed the assessment work required by law for each mining claim listed prior to filing this waiver and understand that by filing this form, an affidavit of assessment work must be recorded by the December 30th following the filing of this waiver.
4. The undersigned understand that if the assessment work obligation has not yet come due under 30 U.S.C. 28 (for those claims in their first assessment year only), a notice of intent to hold reciting this condition must be recorded by the December 30th following the filing of this waiver.
5. The undersigned understand that mill and tunnel sites may also be listed upon this waiver and be waived from payment of the maintenance fee, and that a notice of intent to hold for these sites is required to be recorded by the December 30th immediately following the filing of this waiver.
6. The undersigned understand and acknowledge that pursuant to 43 U.S.C. 1212 and 18 U.S.C. 1001, the filing or recording of a false, fictitious, or fraudulent document with the Bureau of Land Management may result in a fine of up to \$250,000, a prison term not to exceed five years, or both.
7. The mining claims, mill or tunnel sites for which this waiver from payment of the maintenance fees is requested are:

CLAIM OR SITE NAME	BLM RECORDATION SERIAL NUMBER
1. <u>Brycrite #1</u>	<u>364455</u>
2. <u>Golden Gate</u>	<u>363097</u>
3. <u>Banner</u>	<u>363098</u>
4. <u>Mitchell #1</u>	<u>364338</u>
5. <u>Mitchell #2</u>	<u>364339</u>
6. <u>Mitchell #3</u>	<u>364822</u>
7. <u>Mitchell No. 4</u>	<u>394709</u>
8. <u>Mitchell No. 5</u>	<u>394710</u>
9. <u>Leland No. 4</u>	<u>394708</u>
10. <u>Leland No. 3</u>	<u>394711</u>

The owner(s) (claimants) of the above mining claims and sites are:

Maurice Walsh
(Owner's Name - Please Print)
6082 Moonlight Dr
(Street or P.O. Box)
Las Vegas NV 89130
(City) (State) (Zip Code)

Maurice Walsh
(Owner's Signature)

ENTERED
AC 483
SEP 11 2014
BY: pb

(Owner's Name - Please Print)

(Street or P.O. Box)

(City) (State) (Zip Code)

(Owner's Signature)

RECEIVED
BLM AZ STATE OFFICE
2014 AUG 15 P 1:03
PHOENIX, ARIZONA

NW CHECKED SEP 22 2014
(City) (State) (Zip Code)

(Owner's Signature)

(Owner's Name - Please Print)	(Owner's Signature)
(Street or P.O. Box)	(City) (State) (Zip Code)
(Owner's Name - Please Print)	(Owner's Signature)
(Street or P.O. Box)	(City) (State) (Zip Code)
(Owner's Name - Please Print)	(Owner's Signature)
(Street or P.O. Box)	(City) (State) (Zip Code)
(Owner's Name - Please Print)	(Owner's Signature)
(Street or P.O. Box)	(City) (State) (Zip Code)

Title 18 U.S.C. Section 1001 and Title 43 U.S.C. Section 1212 makes it a crime for any person knowingly and willfully to make to any department or agency of the United States any false, fictitious or fraudulent statements or representations as to any matter within its jurisdiction.

INSTRUCTIONS

1. This certification is made under the provisions of §1744 of Title 43 and § 28-28k of Title 30 of the United States Code; and the regulations thereunder (43 CFR Part 3830).
2. The claimant(s) must fill in the dates in paragraph 1 for the beginning and ending of the assessment year for which this waiver is sought.
3. The claimant(s) must fill in the date in paragraph 2 for the beginning of the assessment year for which this waiver is sought.
4. All claim and site names and Bureau of Land Management (BLM) serial numbers must be listed for the mining claims, mill sites, and tunnel sites for which the waiver is sought.
5. All owners of the mining claims, mill sites, and tunnel sites and their addresses must be given.
6. This waiver form must be signed by all the claimants or their designated agent, in original form. If an agent is designated, a notarized designation of agent, signed by all of the claimants with proper address given, must be submitted with this waiver.
7. This form must be filed no later than September 1st for the upcoming assessment year in the BLM State Office where the mining claims or sites are recorded, or the waiver cannot be granted by the BLM. (Example: To obtain a waiver for the assessment year 2012, which begins on September 1, 2011, you must qualify for and file for a waiver no later than September 1, 2011, in the proper BLM State Office.)
8. For all mining claims which require assessment work, you must record an affidavit of labor on or before the December 30th immediately following the filing of this waiver. For all other mining claims or sites waived, you must record a notice of intent to hold on or before the December 30th immediately following the filing of this waiver.
9. Mill and tunnel sites may also be listed upon this waiver and be waived from payment of the maintenance fee. A notice of intent to hold for these sites is required to be filed by the December 30th following the filing of this waiver.

FOR OFFICIAL USE ONLY

M. Walsh
6082 Moonlight Dr
Las Vegas, NV 89130

RECEIVED
BLM AZ STATE OFFICE

2014 AUG 15 P 1:03

PHOENIX, ARIZONA

Bureau of Land Management
Arizona State Office
1 North Central Ave, Suite 800
Phoenix, Az
85004

PRIORITY®
★ MAIL ★

FLAT RATE ENVELOPE
ONE RATE ★ ANY WEIGHT*

APPLY PRIORITY MAIL POSTAGE HERE



1024

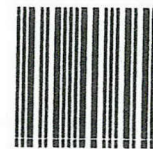

85004

U.S. POSTAGE
PAID
LAS VEGAS, NV
89130
AUG 13, 14
AMOUNT

\$5.60
00065928-02



USPS TRACKING #

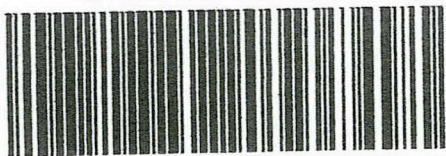

9114 9999 4423 8550 5536 92

LAB400R Aug. 2013
7690-17-000-0669

* For international shipments, the maximum weight is 4 lbs.

EP14H July 2013 Outer Dimension: 10 x 5

PRIORITY®
★ MAIL ★

FLAT RATE ENVELOPE
ONE RATE ★ ANY WEIGHT*



* Domestic only.

PRESS FIRMLY TO SEAL

RECEIVED
BLM AZ STATE OFFICE

2014 AUG 15 P 1:04

PRESS FIRMLY TO SEAL

PHOENIX, ARIZONA

PRIORITY®
★ MAIL ★



 DATE OF DELIVERY SPECIFIED*

 USPS TRACKING™ INCLUDED*

 INSURANCE INCLUDED*

 PICKUP AVAILABLE

* Domestic only

VISIT US AT USPS.COM®
ORDER FREE SUPPLIES ONLINE

EP14H July 2013
OD: 10 x 5



PS00001000064

EP14H © U.S. Postal Service; July 2013; All rights reserved.

This packaging is the property of the U.S. Postal Service® and is provided solely for use in sending Priority Mail® shipments. Misuse may be a violation of federal law. This packaging is not for resale.

364455
363097
364338
364822

394708

When Recorded Return Document to:

Maurcen Walsh
6082 Moonlight Dr
Las Vegas, NV 89130

Check here is this is a change of address.

Telephone: 702-645-3178

E-mail address: mor.walsh@earthlink.net

FEE# 2013061218

OFFICIAL RECORDS
OF MOHAVE COUNTY
CAROL MEIER,
COUNTY RECORDER



12/06/2013 09:00 AM Fee: \$15.00

PAGE: 1 of 2

AFFIDAVIT OF PERFORMANCE OF ANNUAL WORK

- 1. State of Arizona, County of Mohave ss:
- 2. I (Name) Maurcen Walsh
- 3. Reside at (Address) 6082 Moonlight Dr

BLM
Date
Stamp

City Las Vegas County Clark

State NV Zip 89130 being duly sworn, depose and say that I am a citizen of the United States, more than eighteen years of age, and that all of the facts set forth in this affidavit, subject to the provisions and penalties of 18 U.S.C. 1001 pertaining to the filing of false, fictitious, or fraudulent statements with the United States, are true and correct according to the best of my knowledge, information and belief.

4. Owner's name and address (If not shown in Items 1-3 above).

5. That I am personally acquainted with the mining claim(s). The work and improvements were made by and at the expense of the owner(s) of said claim(s). Said contiguous group of claims, listed on this document, are situated in the

San Francisco (optional) Mining District; Mohave County, Arizona.

Line No.	AMC NUMBER	CLAIM/SITE NAME	COUNTY RECORDER DATA (If available)	TWP	RNG	SEC
1	364455	Brucite #1	B: 5415 P: 210	19 N	20 W	7 SE 8 SW
2	363097	Golden Gate	B: 5330 P: 769	19 N	20 W	20 NE 20 NW
3	363098	Banner	B: 5338 P: 771	19 N	20 W	20 NE 35 SE
4	364338	Mitchell #1	B: 5413 P: 513	19 N	20 W	20 NW
5	364339	Mitchell #2	B: 5413 P: 511	19 N	20 W	20 NW 20 NE
6	364822	Mitchell #3	B: 5539 P: 798	19 N	20 W	20 NE 20 SW 35 SE

Form: MCF108
Revised Jan. 2006
Page 1 of 2

ENTERED
DEC 12 2013
BY: [Signature]

BLM RECEIVED
 Date BLM AT STATE OFFICE
 Stamp
 2013 DEC -9 PM 2: 25
 PHOENIX, ARIZONA

7	394709	Mitchell No 4	B: 7320 P: 786	19 N	20 W	20 NW
8	394710	Mitchell No 5	B: 7320 P: 788	19 N	20 W	20 NW SW
9	394708	Leland No 4	B: 7320 P: 784	19 N	20 W	17 SW 20 NW
10	394711	Leland No 3	B: 7320 P: 782	19 N	20 W	17 SW SE

6. That between the dates starting at 12 o'clock noon on September 1, 20 12 and ending at 12 o'clock noon on September 1, 20 13 at least \$ 1600.00 dollars worth of work and improvements were done and performed upon said claim(s) or upon one or more of a contiguous group of claims for the benefit of all, wholly or partly outside of a contiguous group of claims for the benefit of all, not including the location work.

7. That the following persons were employed to perform the work and improvements described herein: _____

8. That the work and improvements performed were: Drywashing, sampling, road repair, brush clearing

9. Dated: 12/6/13 Signature: [Signature]

SUBSCRIBED AND SWORN TO before me, a Notary Public, this 6th day of December 20 13

By: [Signature]

Notary Public Arizona, Mohave

My Commission Expires 8/31/17

Bureau of Land Management
 Arizona State Office
www.az.blm.gov

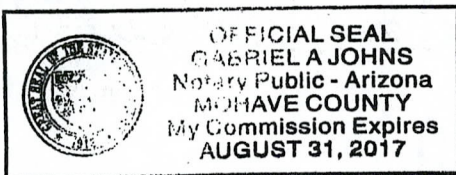

No. of Claims: 10 x \$10 = \$100.00
 Check No.: M.O. 1 Init. CAJ
 Receipt No.: 2927515
 For BLM Use Only

Form: MCF108
 Revised Jan. 2006
 Page 2 of 2

Maureen Walsh
6082 Moonlight Dr
Las Vegas, NV 89130

Bureau of Land Management
Arizona Office
1 North Central Ave, Suite 800
Phoenix, Arizona

70058

RECEIVED
BLM AZ STATE OFFICE
2013 DEC -5 PM 2:25
PHOENIX, ARIZONA



UNITED STATES POSTAL SERVICE®

Apply Priority Mail Postage Here

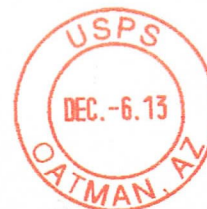

Chasen



USPS TRACKING #



9114 9010 7574 2420 6824 88

Label 400 Jan. 2013
7690-16-000-7848



Maureen Walsh
6082 Moonlight Dr
Las Vegas, NV 89130

Bureau of Landmanagement
Arizona Office
1 North Central Ave, Suite 800
Phoenix, Arizona
85004

PHOENIX, ARIZONA
2013 DEC -9 PM 2:25
RECEIVED
BLM STATE OFFICE



**PRIORITY
MAIL**

UNITED STATES POSTAL SERVICE®

www.usps.com

©USPS 1995

RECEIVED
2013 OCT -9 PM 2:
PHOENIX, ARIZONA

**Mail bearing stamp postage inside the mailer must be canceled
by U.S. Postal Service prior to inserting into mailer.**

HOW TO USE:

1. Place pre-addressed envelope inside this Priority Mail mailer.
 - Make sure the address shows through the window
 - Any postage placed on the envelope must appear in the window area

United States Department of the Interior
Bureau of Land Management
 LANDS/RECREATION & PLANNING
 ONE N CENTRAL AVE
 PHOENIX, AZ 85004 -2203
 Phone: 602-417-9200

Receipt

No: 2927515

Transaction #: 3014789	
Date of Transaction: 12/10/2013	
CUSTOMER:	
MAUREEN WALSH 6082 MOONLIGHT DR LAS VEGAS,NV 89130-1017 US	

LINE #	QTY	DESCRIPTION	REMARKS	UNIT PRICE	TOTAL
1	1.00	LOCATABLE MINERALS / MINING CLAIMS- NOT NEW-UNADJUD,ONE AUTH NO. ONLY / MINING CLAIM MONEY RECEIVED CASES: AMC364455/\$100.00	POL (10) 2013	- n/a -	100.00
TOTAL:					\$100.00

PAYMENT INFORMATION					
1	AMOUNT:	100.00	POSTMARKED:	12/06/2013	
	TYPE:	CHECK	RECEIVED:	12/09/2013	
	CHECK NO:	51008246864			
	NAME:	WALSH, MAUREEN 6082 MOONLIGHT DR LAS VEGAS NV 89130-1017 US			

REMARKS	

This receipt was generated by the automated BLM Collections and Billing System and is a paper representation of a portion of the official electronic record contained therein.

UNITED STATES
DEPARTMENT OF THE INTERIOR
BUREAU OF LAND MANAGEMENT

Amc 364455

363097

364338

364822

FORM APPROVED

OMB NO. 1004-0114

Expires: August 31, 2013

MAINTENANCE FEE WAIVER CERTIFICATION

259

Amc 394708

SEE INSTRUCTIONS ON PAGE 2

1. This small miner waiver is filed for the assessment year beginning on September 1, 13 and ending on September 1, 14. United States of America on September 1, 13.
2. The undersigned and all related parties owned ten or fewer mining claims, mill, or tunnel sites located and maintained on Federal lands in the United States of America on September 1, 13.
3. The undersigned have performed the assessment work required by law for each mining claim listed prior to filing this waiver and understand that by filing this form, an affidavit of assessment work must be recorded by the December 30th following the filing of this waiver.
4. The undersigned understand that if the assessment work obligation has not yet come due under 30 U.S.C. 28 (for those claims in their first assessment year only), a notice of intent to hold reciting this condition must be recorded by the December 30th following the filing of this waiver.
5. The undersigned understand that mill and tunnel sites may also be listed upon this waiver and be waived from payment of the maintenance fee, and that a notice of intent to hold for these sites is required to be recorded by the December 30th immediately following the filing of this waiver.
6. The undersigned understand and acknowledge that pursuant to 43 U.S.C. 1212 and 18 U.S.C. 1001, the filing or recording of a false, fictitious, or fraudulent document with the Bureau of Land Management may result in a fine of up to \$250,000, a prison term not to exceed five years, or both.
7. The mining claims, mill or tunnel sites for which this waiver from payment of the maintenance fees is requested are:

CLAIM OR SITE NAME	BLM RECORDATION SERIAL NUMBER
1. <u>Brucite #1</u>	<u>364455</u>
2. <u>Golden Gate</u>	<u>363097</u>
3. <u>Banner</u>	<u>363098</u>
4. <u>Mitchell #1</u>	<u>364338</u>
5. <u>Mitchell #2</u>	<u>364339</u>
6. <u>Mitchell #3</u>	<u>364822</u>
7. <u>Mitchell No. 4</u>	<u>394709</u>
8. <u>Mitchell No. 5</u>	<u>394710</u>
9. <u>Leland No. 4</u>	<u>394708</u>
10. <u>Leland No. 3</u>	<u>394711</u>

The owner(s) (claimants) of the above mining claims and sites are:

Maureen Walsh ✓
 (Owner's Name - Please Print)
6082 Moonlight Dr
 (Street or P.O. Box)
Las Vegas NV 89130
 (City) (State) (Zip Code)

Maureen Walsh
 (Owner's Signature)

 (Owner's Name - Please Print)

 (Street or P.O. Box)

 (City) (State) (Zip Code)

 (Owner's Signature)

 (Owner's Name - Please Print)

 (Street or P.O. Box)

 (City) (State) (Zip Code)

ENTERED INTO COMPUTER
 SEP 19 2013 RS

RECEIVED
 BLM ASST. DIR. OFFICE
 2013 SEP 12 PM 2:38
 PHOENIX, ARIZONA

10/PB

(Owner's Name - Please Print)

(Owner's Signature)

(Street or P.O. Box)

(City)

(State)

(Zip Code)

(Owner's Name - Please Print)

(Owner's Signature)

(Street or P.O. Box)

(City)

(State)

(Zip Code)

(Owner's Name - Please Print)

(Owner's Signature)

(Street or P.O. Box)

(City)

(State)

(Zip Code)

(Owner's Name - Please Print)

(Owner's Signature)

(Street or P.O. Box)

(City)

(State)

(Zip Code)

Title 18 U.S.C. Section 1001 and Title 43 U.S.C. Section 1212 makes it a crime for any person knowingly and willfully to make to any department or agency of the United States any false, fictitious or fraudulent statements or representations as to any matter within its jurisdiction.

INSTRUCTIONS

1. This certification is made under the provisions of §1744 of Title 43 and § 28-28k of Title 30 of the United States Code; and the regulations thereunder (43 CFR Part 3830).
2. The claimant(s) must fill in the dates in paragraph 1 for the beginning and ending of the assessment year for which this waiver is sought.
3. The claimant(s) must fill in the date in paragraph 2 for the beginning of the assessment year for which this waiver is sought.
4. All claim and site names and Bureau of Land Management (BLM) serial numbers must be listed for the mining claims, mill sites, and tunnel sites for which the waiver is sought.
5. All owners of the mining claims, mill sites, and tunnel sites and their addresses must be given.
6. This waiver form must be signed by all the claimants or their designated agent, in original form. If an agent is designated, a notarized designation of agent, signed by all of the claimants with proper address given, must be submitted with this waiver.
7. This form must be filed no later than September 1st for the upcoming assessment year in the BLM State Office where the mining claims or sites are recorded, or the waiver cannot be granted by the BLM. (Example: To obtain a waiver for the assessment year 2012, which begins on September 1, 2011, you must qualify for and file for a waiver no later than September 1, 2011, in the proper BLM State Office.)
8. For all mining claims which require assessment work, you must record an affidavit of labor on or before the December 30th immediately following the filing of this waiver. For all other mining claims or sites waived, you must record a notice of intent to hold on or before the December 30th immediately following the filing of this waiver.
9. Mill and tunnel sites may also be listed upon this waiver and be waived from payment of the maintenance fee. A notice of intent to hold for these sites is required to be filed by the December 30th following the filing of this waiver.

RECEIVED
BLM AZ STATE OFFICE
PHOENIX, ARIZONA
2011 APR 12 PM 2:30

FOR OFFICIAL USE ONLY

M. Walsh
6082 Moonlight Dr
Las Vegas, NV 89130

RECEIVED
BLM

2013 JUN 19 AM 2:26

PHOENIX, ARIZONA

Bureau of Land Management
Arizona State Office
1 North Central Ave, Ste 800
Phoenix, AZ 85004



Apply Priority Mail Postage Here

UNITED STATES POSTAL SERVICE

TR - Walsh
6082 Montlight Dr
Las Vegas, NV 89130



1024

85004

U.S. POSTAGE
PAID
BOULDER CITY, NV
89005
AUG 08, '13
AMOUNT

\$5.60

00098074-03

RECEIVED
BLM AZ
2013 AUG 16
PHOENIX, ARIZONA
USPS TRACKING NUMBER



9505 5109 8074 3220 5034 11

Bureau of Land Management
Arizona State Office
1 North Central Ave, Ste 800
Phoenix, AZ 85004

When Recorded Return Document to:

Maurcen Walsh
6082 Moonlight Dr
Las Vegas, NV 89130

FEE# 2012064815

OFFICIAL RECORDS
OF MOHAVE COUNTY
CAROL MEIER,
COUNTY RECORDER



Check here is this is a change of address.

Telephone: 702-645-3178

E-mail address: mocwalsh@earthlink.net

12/14/2012 08:25 AM Fee: \$15.00

PAGE: 1 of 2 Amc 364455

363097

364338

364822

394708

AFFIDAVIT OF PERFORMANCE OF ANNUAL WORK

1. State of Arizona, County of Mohave ss:

2. I (Name) Maurcen Walsh

3. Reside at (Address) 6082 Moonlight Dr

City Las Vegas County Clark

State NV Zip 89130 being duly sworn, depose and say that I am a citizen of the United States, more than eighteen years of age, and that all of the facts set forth in this affidavit, subject to the provisions and penalties of 18 U.S.C. 1001 pertaining to the filing of false, fictitious, or fraudulent statements with the United States, are true and correct according to the best of my knowledge, information and belief.

4. Owner's name and address (If not shown in Items 1-3 above).

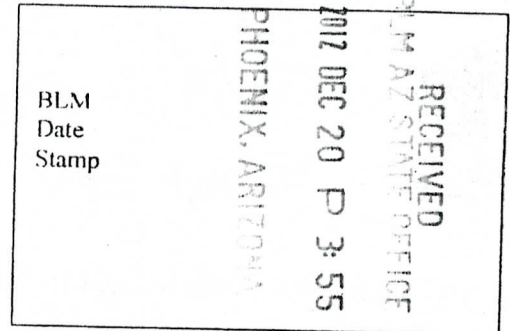

5. That I am personally acquainted with the mining claim(s). The work and improvements were made by and at the expense of the owner(s) of said claim(s). Said contiguous group of claims, listed on this document, are situated in the

San Francisco (optional) Mining District; Mohave County, Arizona.

Line No.	AMC NUMBER	CLAIM/SITE NAME	COUNTY RECORDER DATA (If available)	TWP	RNG	SEC
1	364455	Bruceite #1	B: 5415 P: 210	19N	20W	7 SE 8 SW
2	363097	Golden Gate	B: 5330 P: 769	19N	20W	20 NE 20 NW
3	363098	Banner	B: 5330 P: 771	19N	20W	NE SE NW
4	364338	Mitchell #1	B: 5413 P: 513	19N	20W	20 NW
5	364339	Mitchell #2	B: 5413 P: 511	19N	20W	NW 20 NE
6	364822	Mitchell #3	B: 5539 P: 798	19N	20W	20 NE NW SW SE

1/17/13 AT

RECEIVED
 BLM ARIZONA STATE OFFICE
 2012 DEC 20 P 3:55
 PHOENIX, ARIZONA
 BLM
 Date
 Stamp

7	394709	Mitchell No 4	B: 7320 P: 786	19N	20W	20NW
8	394710	Mitchell No 5	B: 7320 P: 788	19N	20W	20NW 20SW
9	394708	Leland No 4	B: 7320 P: 784	19N	20W	17SW 20NW
10	394711	Leland No 3	B: 7320 P: 782	19N	20W	17SW 17SE

6. That between the dates starting at 12 o'clock noon on September 1, 20 11 and ending at 12 o'clock noon on September 1, 20 12 at least \$ 1750.00 dollars worth of work and improvements were done and performed upon said claim(s) or upon one or more of a contiguous group of claims for the benefit of all, wholly or partly outside of a contiguous group of claims for the benefit of all, not including the location work.

7. That the following persons were employed to perform the work and improvements described herein: _____

8. That the work and improvements performed were: Sampling, dry washing, repair flood-damaged roads

9. Dated: 12/14/12 Signature: Lawren Wash

SUBSCRIBED AND SWORN TO before me, a Notary Public, this 14th day of December 20 12

By: Rob. M. Foreman

Notary Public Rob M Foreman

My Commission Expires June 21, 2014

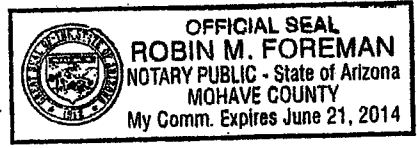

Bureau of Land Management
 Arizona State Office
www.az.blm.gov

No. of Claims: 10 x \$10 = 100
 Check No.: 4406 Init. me
 Receipt No.: 2714854
 For BLM Use Only

Mr. Walsh
6082 Moonlight Dr
Las Vegas, NV 89130

RECEIVED
BLM AZ STATE OFFICE

2012 DEC 20 P 3:55

PHOENIX, ARIZONA

United States Department of the Interior
Bureau of Land Management
Arizona State Office
1 North Central Ave, Suite 800
Phoenix, AZ 85004



Apply Priority Mail Postage Here

U.S. POSTAGE
PAID
BOULDER CITY, NV
89005-12
DEC 17 12
AMOUNT
\$5.90
00027083-05

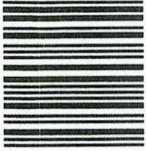

85004



1024

United States Postal Service®
DELIVERY CONFIRMATION™

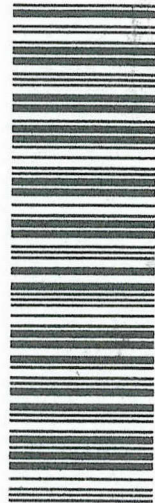

0312 1430 0002 6101 3234

RECEIVED
BLM AZ S OFFICE
2012 DEC 20 P 3 49
PHOENIX, ARIZO

United States Department of the Interior
Bureau of Land Management

Receipt

LANDS/RECREATION & PLANNING
ONE N CENTRAL AVE
PHOENIX, AZ 85004 -2203
Phone: 602-417-9200

No:

2714854

Transaction #: 2797235	ENTERED INTO COMPUTER
Date of Transaction: 12/28/2012	
CUSTOMER:	
MAUREEN WALSH 6082 MOONLIGHT DR LAS VEGAS, NV 89130-1017 US	

LINE #	QTY	DESCRIPTION	REMARKS	UNIT PRICE	TOTAL
1	1.00	LOCATABLE MINERALS / MINING CLAIMS-NOT NEW-UNADJUD, ONE AUTH NO. ONLY / MINING CLAIM MONEY RECEIVED CASES: AMC364455/\$100.00	POL 2012/10	- n/a -	100.00
TOTAL:					\$100.00

PAYMENT INFORMATION					
1	AMOUNT:	100.00	POSTMARKED:	N/A	
	TYPE:	CHECK	RECEIVED:	12/20/2012	
	CHECK NO:	4406			
	NAME:	WALSH, MAUREEN 6082 MOONLIGHT DR LAS VEGAS NV 89130-1017 US			

REMARKS
ISSUED ON TEMP RECEIPT 181607

This receipt was generated by the automated BLM Collections and Billing System and is a paper representation of a portion of the official electronic record contained therein.

FEB 06 2013 Lead Amc # (15)
 Amc 364455
 363097
 364338
 364822
 394.708

UNITED STATES
DEPARTMENT OF THE INTERIOR
BUREAU OF LAND MANAGEMENT

MAINTENANCE FEE WAIVER CERTIFICATION

AMC 394708
AMC 364822
AMC 364338
FORM APPROVED (282)
OMB NO. 1004-0114
Expires: August 31, 2013
AMC 363097
AMC 364455

SEE INSTRUCTIONS ON PAGE 2

(PB)

- This small miner waiver is filed for the assessment year beginning on September 1, 12 and ending on September 1, 13.
- The undersigned and all related parties owned ten or fewer mining claims, mill, or tunnel sites located and maintained on Federal lands in the United States of America on September 1, 12.
- The undersigned have performed the assessment work required by law for each mining claim listed prior to filing this waiver and understand that by filing this form, an affidavit of assessment work must be recorded by the December 30th following the filing of this waiver.
- The undersigned understand that if the assessment work obligation has not yet come due under 30 U.S.C. 28 (for those claims in their first assessment year only), a notice of intent to hold reciting this condition must be recorded by the December 30th following the filing of this waiver.
- The undersigned understand that mill and tunnel sites may also be listed upon this waiver and be waived from payment of the maintenance fee, and that a notice of intent to hold for these sites is required to be recorded by the December 30th immediately following the filing of this waiver.
- The undersigned understand and acknowledge that pursuant to 43 U.S.C. 1212 and 18 U.S.C. 1001, the filing or recording of a false, fictitious, or fraudulent document with the Bureau of Land Management may result in a fine of up to \$250,000, a prison term not to exceed five years, or both.
- The mining claims, mill or tunnel sites for which this waiver from payment of the maintenance fees is requested are:

CLAIM OR SITE NAME	BLM RECORDATION SERIAL NUMBER
1. <u>Brucite #1</u>	<u>364455</u>
2. <u>Golden Gate</u>	<u>363097</u>
3. <u>Banner</u>	<u>363098</u>
4. <u>Mitchell #1</u>	<u>364338</u>
5. <u>Mitchell #2</u>	<u>364339</u>
6. <u>Mitchell #3</u>	<u>364822</u>
7. <u>Mitchell No 4</u>	<u>394709</u>
8. <u>Mitchell No 5</u>	<u>394710</u>
9. <u>Leland No 4</u>	<u>394708</u>
10. <u>Leland No 3</u>	<u>394711</u>

The owner(s) (claimants) of the above mining claims and sites are:

Maurice Walsh
(Owner's Name - Please Print)
6082 Moonlight Dr
(Street or P.O. Box)
Las Vegas NV 89130
(City) (State) (Zip Code)

Maurice Walsh
(Owner's Signature)

(Owner's Name - Please Print)

(Street or P.O. Box)

(City) (State) (Zip Code)

(Owner's Signature)

(Owner's Name - Please Print)

(Street or P.O. Box)

(City) (State) (Zip Code)

ENTERED IN COMPUTER
RE 8-30-12

RECEIVED
BLM AZ STATE OFFICE
2012 AUG 16 11:20
PHOENIX, ARIZONA

(Owner's Name - Please Print)

(Owner's Signature)

(Street or P.O. Box)

(City)

(State)

(Zip Code)

(Owner's Name - Please Print)

(Owner's Signature)

(Street or P.O. Box)

(City)

(State)

(Zip Code)

(Owner's Name - Please Print)

(Owner's Signature)

(Street or P.O. Box)

(City)

(State)

(Zip Code)

(Owner's Name - Please Print)

(Owner's Signature)

(Street or P.O. Box)

(City)

(State)

(Zip Code)

Title 18 U.S.C. Section 1001 and Title 43 U.S.C. Section 1212 makes it a crime for any person knowingly and willfully to make to any department or agency of the United States any false, fictitious or fraudulent statements or representations as to any matter within its jurisdiction.

INSTRUCTIONS

1. This certification is made under the provisions of §1744 of Title 43 and § 28-28k of Title 30 of the United States Code; and the regulations thereunder (43 CFR Part 3830).
2. The claimant(s) must fill in the dates in paragraph 1 for the beginning and ending of the assessment year for which this waiver is sought.
3. The claimant(s) must fill in the date in paragraph 2 for the beginning of the assessment year for which this waiver is sought.
4. All claim and site names and Bureau of Land Management (BLM) serial numbers must be listed for the mining claims, mill sites, and tunnel sites for which the waiver is sought.
5. All owners of the mining claims, mill sites, and tunnel sites and their addresses must be given.
6. This waiver form must be signed by all the claimants or their designated agent, in original form. If an agent is designated, a notarized designation of agent, signed by all of the claimants with proper address given, must be submitted with this waiver.
7. This form must be filed no later than September 1st for the upcoming assessment year in the BLM State Office where the mining claims or sites are recorded, or the waiver cannot be granted by the BLM. (Example: To obtain a waiver for the assessment year 2012, which begins on September 1, 2011, you must qualify for and file for a waiver no later than September 1, 2011, in the proper BLM State Office.)
8. For all mining claims which require assessment work, you must record an affidavit of labor on or before the December 30th immediately following the filing of this waiver. For all other mining claims or sites waived, you must record a notice of intent to hold on or before the December 30th immediately following the filing of this waiver.
9. Mill and tunnel sites may also be listed upon this waiver and be waived from payment of the maintenance fee. A notice of intent to hold for these sites is required to be filed by the December 30th following the filing of this waiver.

RECEIVED
 BLM AZ STATE OFFICE
 PHOENIX, ARIZONA
 2012 AUG 16 A 11:20
 FOR OFFICIAL USE ONLY

2

Amc 364455
Amc 363097
Amc 364338
Amc 364822
Amc 394708



FEE# 2011060844

OFFICIAL RECORDS
OF MOHAVE COUNTY
CAROL MEIER,
COUNTY RECORDER



12/02/2011 02:25 PM Fee: \$19.00

PAGE: 1 of 2

Return Document to:

Maureen Walsh
6082 Moonlight Dr
Las Vegas NV 89130

Telephone: 702-645-3178

RECEIVED
BLM AZ OFFICE
2011 DEC -7 PM 1:49
PHOENIX, ARIZONA
BLM Date Stamp

SELECT ONLY ONE:

AFFIDAVIT OF PERFORMANCE OF ANNUAL WORK. Also fill in Items 1 through 9 on the reverse side of this document.

NOTICE OF INTENTION TO HOLD. I intend to hold the claims(s)/site(s) listed below for the calendar year 20___. Also fill in Items 1 through 4 and Item 9 on the reverse side of this document.

AMC NUMBER	CLAIM/SITE NAME	COUNTY RECORDER DATA	SEC	TWP	RANGE
364455	Brucite # 1	B: 3415 P: 210	7 S.E. 8 S.W.	19N	20W
363097	Golden Gate	B: 5330 P: 769	20 N.E. 20 N.W.	19W	20W
363098	Banner	B: 5330 P: 771	20 S.E. 20 N.W.	19W	20W
364338	Mitchell # 1	B: 5413 P: 513	20 N.W.	19W	20W
364339	Mitchell # 2	B: 5413 P: 511	20 N.E.	19W	20W
364822	Mitchell # 3	B: 5539 P: 798	20 S.E. 20 S.W.	19W	20W
394709	Mitchell No 4	B: 7320 P: 786	20 N.W.	19W	20W
394710	Mitchell No 5	B: 7320 P: 788	20 S.W.	19W	20W
394708	Leland No 4	B: 7320 P: 784	17 S.W. 20 N.W.	19W	20W
394711	Leland No 3	B: 7320 P: 782	17 S.W. 17 S.E.	19W	20W

BLM requires a \$5 nonrefundable service charge for each mining claim, mill site or tunnel site payable on or before December 30th (not the 31st). Mail to:

Bureau of Land Management
222 North Central Avenue
Phoenix, Arizona 85004-2203
602-417-9200
www.az.blm.gov

NO. OF CLAIMS 10 X \$5 = 100.00
CHECK NO. 2478014 INIT SM
BLM USE ONLY

ENTERED INTO COMPUTER

12/13/11 AT

AZ-3850-1
(December 2003)

Notices of Intention to Hold are for mill sites, tunnel sites or mining claims when assessment work has not been done, regardless of whether the annual assessment has been suspended, deferred, or not yet accrued. The filing of a Notice of Intention to Hold shall not relieve the owner of complying with Federal and State laws pertaining to the performance of annual assessment work. Notices of Intention to Hold for mill sites or tunnel sites need not be county recorded. For mining claims the form filed with the Bureau of Land Management must be identical to the one that was or will be filed with the County. All claims listed on a single affidavit must be contiguous.

Evidence of Annual Assessment Work or a Notice of Intention to Hold must be filed each calendar year following the calendar year in which the claim/site was located.

1. State of Arizona, County of Mohave ss:

2. I, (Name) Maurcen Walsh

3. Reside at (Address) 4082 Moorlight Dr

City Las Vegas County Clark State Nevada Zip 89130 being duly sworn, depose and say that I am a citizen of the United States, more than eighteen years of age, that all of the facts set forth in this affidavit/notice, subject to the provisions and penalties of 18 U.S.C. 1001 pertaining to the filing of false, fictitious, or fraudulent statements with the United States, are true and correct according to the best of my knowledge, information and belief.

4. Owner's name and address (If not shown in Items 1-3 above) _____

5. That I am personally acquainted with the mining claim(s). The work and improvements were made by and at the expense of the owner(s) of said claim(s). Said contiguous group of claims, listed on the reverse side of this document, are situated in the San Francisco Mining District, Mohave County, Arizona.

6. That between the dates starting at 12 o'clock noon on September 1, 2010 and ending at 12 o'clock noon on September 1, 2011 at least \$ 1450 dollars worth of work and improvements were done and performed upon said claim(s) or upon one or more of a contiguous group of claims for the benefit of all, wholly or partly outside of a contiguous group of claims for the benefit of all, not including the location work.

7. That the following persons were employed to perform the work and improvements described herein: _____

8. That the work and improvements performed were: Sampling Waches & Tailings Piles
Road Maintenance Cleaning Brush

9. Dated: 12-2-11 Signature: Maurcen Walsh

SUBSCRIBED AND SWORN TO before me, a Notary Public, this 2ND day of December 20 11

By: MAURCEN WALSH
Notary Public Robin Foreman

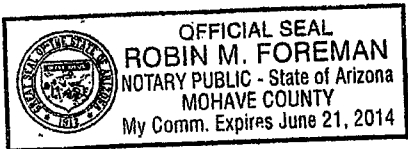

MY COMMISSION EXPIRES JUNE 21, 2014

PRIVACY ACT STATEMENT - This information is being collected pursuant to 30 U.S.C. 28, 43 CFR 3833.2, and ARS 27-208, in compliance with the laws of the USDI, Bureau of Land Management, and the State of Arizona. The purpose of this collection is to facilitate processing of claims or applications. This form is covered by Privacy Act Notice #INTERIOR/LLM-32 and is subject to the routine uses stated in that notice. Privacy Act Notice #INTERIOR/LLM-32 is available at the BLM Arizona State Office. This form may be locally reproduced.

AZ-3850-1
(December 2003)

RECEIVED
BLM ARIZONA STATE OFFICE
DEC 7 7 PM 1:50

Mr. Walsh
6082 Moonlight Dr
Las Vegas, NV 89130



Bureau of Land Management
One North Central Ave
Suite 800
Phoenix, AZ 85004

Place
stamp
here

RECEIVED
BLM AZ STATE OFFICE
2011 DEC -7 PM 1:49
PHOENIX, ARIZONA

United States Department of the Interior
 Bureau of Land Management
 LANDS/RECREATION & PLANNING
 ONE N CENTRAL AVE
 PHOENIX, AZ 85004 -2203
 Phone: 602-417-9200

Receipt

No: 2478014

Transaction #: 2554497	
Date of Transaction: 12/08/2011	
CUSTOMER:	
MAUREEN WALSH 6082 MOONLIGHT DR LAS VEGAS,NV 89130-1017 US	

LINE #	QTY	DESCRIPTION	REMARKS	UNIT PRICE	TOTAL
1	1.00	LOCATABLE MINERALS / MINING CLAIMS-NOT NEW-UNADJUD,ONE AUTH NO. ONLY / MINING CLAIM MONEY RECEIVED CASES: AMC364455/\$100.00	POL-10	- n/a -	100.00
TOTAL:					\$100.00

PAYMENT INFORMATION					
1	AMOUNT:	100.00	POSTMARKED:	12/05/2011	
	TYPE:	CHECK	RECEIVED:	12/08/2011	
	CHECK NO:	4017			
	NAME:	WALSH, MAUREEN 6082 MOONLIGHT DR LAS VEGAS NV 89130-1017 US			

REMARKS

This receipt was generated by the automated BLM Collections and Billing System and is a paper representation of a portion of the official electronic record contained therein.

336

AMC 394708

AMC 364822 (22)

AMC 364338

AMC 363097

FORM APPROVED
OMB NO. 1004-0114
Expires: December 31, 2002

AMC 364455

Form 3830-2
(January 2000)

UNITED STATES
DEPARTMENT OF THE INTERIOR
BUREAU OF LAND MANAGEMENT
MAINTENANCE FEE WAIVER CERTIFICATION

SEE INSTRUCTIONS ON REVERSE

1. This small miner waiver is filed for the assessment year beginning at noon on September 1, 11 and ending at noon on September 1, 12.
2. The undersigned and all related parties owned ten or fewer mining claims, mill, or tunnel sites located and maintained on Federal lands in the United States of America on September 1, 11.
3. The undersigned have performed the assessment work **required by law** for each mining claim listed **prior to filing this waiver** and understand that by filing this form; an affidavit of assessment work **must** be recorded by the December 30th following the filing of this waiver.
4. The undersigned understand that if the assessment work obligation has not yet come due under 30 U.S.C. 28 (for those claims in their first assessment year only); a notice of intent to hold reciting this condition **must** be recorded by the December 30th following the filing of this waiver.
5. The undersigned understand that mill and tunnel sites may also be listed upon this waiver and be waived from payment of the maintenance fee; and that a notice of intent to hold for these sites is required to be recorded by the December 30th immediately following the filing of this waiver.
6. The undersigned understand and acknowledge that pursuant to 43 U.S.C. 1212 and 18 U.S.C. 1001; the filing or recording of a false, fictitious, or fraudulent document with the Bureau of Land Management may result in a fine of up to \$250,000, a prison term not to exceed five years, or both.
7. The mining claims, mill or tunnel sites for which this waiver from payment of the maintenance fees is requested are:

CLAIM OR SITE NAME	BLM RECORDATION SERIAL NUMBER
1. <u>Brucite #1</u>	<input checked="" type="checkbox"/> <u>364455</u>
2. <u>Golden Gate</u>	<u>363097</u>
3. <u>Banner</u>	<u>363098</u>
4. <u>Mitchell #1</u>	<u>364338</u>
5. <u>Mitchell #2</u>	<u>364339</u>
6. <u>Mitchell #3</u>	<u>364822</u>
7. <u>Mitchell No 4</u>	<u>394709</u>
8. <u>Mitchell No 5</u>	<u>394710</u>
9. <u>Leland No 4</u>	<u>394708</u>
10. <u>Leland No 3</u>	<u>394711</u>

The owner(s) (claimants) of the above mining claims and sites are:

Maureen Walsh
(Owner's Name - Please Print)
6082 Moonlight Dr
(Street or P.O. Box)
Las Vegas NV 89130
(City) (State) (Zip Code)

Maureen Walsh
(Owner's Signature)

(Owner's Name - Please Print)

(Street or P.O. Box)

(City) (State) (Zip Code)

(Owner's Signature)

(Owner's Name - Please Print)

(Street or P.O. Box)

(City) (State) (Zip Code)

ENTERED IN COMPUTER

RE 8-23-11

RECEIVED
BLM AZ STATE OFFICE
PHOENIX, ARIZONA
2011 AUG 18 PM 2:37

10/20

(Owner's Name - Please Print)

(Owner's Signature)

(Street or P.O. Box)

(City) (State) (Zip Code)

(Owner's Name - Please Print)

(Owner's Signature)

(Street or P.O. Box)

(City) (State) (Zip Code)

(Owner's Name - Please Print)

(Owner's Signature)

(Street or P.O. Box)

(City) (State) (Zip Code)

(Owner's Name - Please Print)

(Owner's Signature)

(Street or P.O. Box)

(City) (State) (Zip Code)

INSTRUCTIONS

1. This certification is made under the provisions of § 1744 of Title 43 and § 28-28k of Title 30 of the United States Code; and the regulations thereunder (43 CFR Part 3830).
2. The claimant(s) must fill in the dates in paragraph 1 for the beginning and ending of the assessment year for which this waiver is sought.
3. The claimant(s) must fill in the date in paragraph 2 for the beginning of the assessment year for which this waiver is sought.
4. All claim and site names and Bureau of Land Management (BLM) serial numbers must be listed for the mining claims, mill sites, and tunnel sites for which the waiver is sought.
5. All owners of the mining claims, mill sites, and tunnel sites and their addresses must be given.
6. This waiver form must be signed by all the claimants or their designated agent, in original form. If an agent is designated, a notarized designation of agent, signed by all of the claimants with proper address given, must be submitted with this waiver.

7. This form must be filed no later than September 1st for the upcoming assessment year in the BLM State Office where the mining claims or sites are recorded, or the waiver cannot be granted by the BLM. (Example: to obtain a waiver for the assessment year 2000, which begins at noon on September 1, 1999, you must qualify for and file for a waiver no later than September 1, 1999 in the proper BLM State Office).
8. For all mining claims which require assessment work, you must record an affidavit of labor on or before the December 30th immediately following the filing of this waiver. For all other mining claims or sites waived, you must record a notice of intent to hold on or before the December 30th immediately following the filing of this waiver.
9. Mill and tunnel sites may also be listed upon this waiver and be waived from payment of the maintenance fee. A notice of intent to hold for these sites is required to be filed by the December 30th following the filing of this waiver.

NOTICE/BURDEN HOURS STATEMENT

The Privacy Act of 1974, as amended, and the regulation in 43 CFR 2.48(d) provide that you be furnished the following information in connection with the information required by this certification of waiver from rental fees.

AUTHORITY: 30 U.S.C. 28-28k; 43 U.S.C. 1201, 1457, 1740, and 1744; and 43 CFR 3830.

PRINCIPLE PURPOSE: This information is to be used to verify that the owner(s) (claimants) of a mining claim has complied with 30 U.S.C. 28f and is entitled to perform assessment work in lieu of paying the maintenance fee for the mining claims listed on this form.

ROUTINE USE: (1) Adjudication of the claimant(s) certification of waiver from paying the maintenance fee otherwise required by 30 U.S.C. 28f. (2) Disclosure may be made to appropriate Federal agencies when location is made within the agency's geographic area of responsibility. (3) Information from the record and/or the record will be transferred to the appropriate Federal, State, or local agency, or a member of the public in response to a specific request for pertinent information. (4) Information may also be provided to the Department of Justice or in a proceeding before a court or adjudicative body; or to Federal, State, local or foreign agencies when needed for enforcement of civil or criminal codes or applicable regulations concerning title rights upon the public land.

EFFECT OF NOT PROVIDING INFORMATION: Disclosure of this information is required by 30 U.S.C. 28f and 43 CFR Part 3830 for those qualified claimants wishing to take the small miner waiver allowed. Failure to supply the information required in this form to support the claimants certification of waiver from payment of the otherwise required maintenance fees will result in the waiver being disallowed and the mining claims subject to forfeiture by BLM under 30 U.S.C. 28i.

The Paperwork Reduction Act of 1995 requires us to inform you that:

This information is being collected to allow the BLM to determine if you qualify for a waiver from the payment of \$100 per mining claim or site maintenance fee established in 30 U.S.C. 28f and the implementing regulations at 43 CFR 3830. A response to this request is required in accordance with the statute to obtain your benefit.

BLM would like you to know that you do not have to respond to this, or any other, Federal agency-sponsored information collection unless it displays a currently valid OMB control number.

Public reporting burden for this form is estimated to average 8 minutes (0.133 hours) per response, including time to review instructions, gathering and maintaining data, and completing and reviewing the form. Direct comments regarding this burden estimate, or any other aspect of this form, to the U.S. Department of the Interior, Bureau of Land Management, (1004-0114) Bureau Clearance Officer (WO-630), Mail Stop 401 LS, 1849 C St., N.W., Washington, D.C. 20240.

FOR OFFICIAL USE ONLY

AMC 364455
AMC 363097
AMC 364338
AMC 364822

AMC 394708

FEE# 2010071873

OFFICIAL RECORDS
OF MOHAVE COUNTY
CAROL MEIER,
COUNTY RECORDER



12/10/2010 08:57 AM Fee: \$19.00

PAGE: 1 of 2

Return Document to:
Maureen Walsh
6082 Moonlight Dr.
Las Vegas N.V. 89130
Telephone: 702-645-3178

A3850-1 (NOV. 2001)

No. of Claims: 10 x \$5 = 100.00
Receipt No.: 22110910 Check No.: _____
Init: SM FOR BLM USE ONLY

- AFFIDAVIT OF PERFORMANCE OF ANNUAL WORK.** Also fill in Items 1 through 9 and the reverse side of this document.
- NOTICE OF INTENTION TO HOLD.** I intend to hold the claims(s)/site(s) listed on the reverse side of this document for the calendar year 20____. Also fill in Items 1 through 4 and Item 9.

Notices of Intention to Hold are for mill sites and tunnel sites or for mining claims when assessment work has not been done, regardless of whether the annual assessment has been suspended, deferred, or not yet accrued. The filing of a Notice of Intention to Hold shall not relieve the owner of complying with federal and state laws pertaining to the performance of annual assessment work. Notices of Intention to Hold for mill sites or tunnel sites need not be county recorded. For mining claims the form filed with the Bureau of Land Management (BLM) must be identical to the one that was or will be filed with the county.

Evidence of Annual Assessment Work or a Notice of Intention to Hold must be filed each calendar year following the calendar year in which the claim/site was located. **All claims listed on a single affidavit must be contiguous.**

1. State of Arizona, County of Mohave ss:
2. I, (Name) Maureen Walsh
3. Reside at (Address) 6082 Moonlight Dr.
City Las Vegas, County Clark, State N.V. Zip 89130

RECEIVED
BLM COUNTY OFFICE
20 DEC 1 A 7:46
MOHAVE ARIZONA

being duly sworn, deposes and says that he/she is a citizen of the United States, more than eighteen years of age, that all of the facts set forth in this affidavit/notice, subject to the provisions and penalties of 18 U.S.C. 1001 pertaining to the filing of false, fictitious, or fraudulent statements with the United States, are true and correct according to the best of my knowledge, information and belief.

4. Owner's name and address (If not shown in Items 1-3 above). Check here if this is a change of address.

5. That I am personally acquainted with the mining claim(s). The work and improvements were made by and at the expense of the owner(s) of said claim(s). Said contiguous group of claims, listed on the reverse side of this document, are situated in the San Francisco Mining District, Mohave County, Arizona.

6. That between the dates starting at 12 o'clock noon on September 1, 209 and ending at 12 o'clock noon on September 1, 2010 at least \$ 1300.00 Dollars worth of work and improvements were done and performed upon said claim(s) or upon one or more of a contiguous group of claims for the benefit of all, or wholly or partly outside of a contiguous group of claims for the benefit of all, not including the location work.

7. That the following persons were employed to perform the work and improvements described herein: _____

ENTERED INTO COMPUTER

8. That the work and improvements performed were: Sampling Dumps, Dry Washing
Road Maintenance Brush Clearing

9. Dated: 12-10-10 Signature: [Signature]
 SUBSCRIBED AND SWORN TO before me, a Notary Public, this 10 day of December, 2010

by Maureen Elizabeth Walsh
 Notary Public Sherie L. Sixkiller-Wing
 MY COMMISSION EXPIRES March 5, 2011

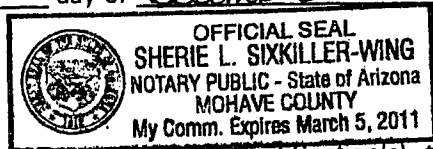

If the claims/sites have consecutive BLM numbers and are in the same Township, Range and Section(s), they may be listed as follows:

Claim/Site Name	Serial Number	Dkt/Pg or Record # of Orig Location Notice	TWN SHP	RNG	SEC(S)
Sample 1 - 10	A MC 19640 - 49	Dkt/Pg 1025/1-10 Recording #9106173-82	4N	20W	36
<u>Brucite # 1</u>	<u>364455</u>	<u>B: 5415 P: 210</u>	<u>19^N 20^W</u>	<u>20</u>	<u>7 S.E. 8 S.W.</u>
<u>Golden Gate</u>	<u>363097</u>	<u>B: 5330 P: 769</u>	<u>19^N 20^W</u>	<u>20</u>	<u>20 N.E.</u>
<u>Banner</u>	<u>363098</u>	<u>B: 5330 P: 771</u>	<u>19^N 20^W</u>	<u>20</u>	<u>20 N.E. 21 N.W.</u>
<u>Mitchell # 1</u>	<u>364338</u>	<u>B: 5413 P: 513</u>	<u>19^N 20^W</u>	<u>20</u>	<u>20 N.W.</u>
<u>Mitchell # 2</u>	<u>364339</u>	<u>B: 5413 P: 511</u>	<u>19^N 20^W</u>	<u>20</u>	<u>20 N.W.</u>
<u>Mitchell # 3</u>	<u>364822</u>	<u>B: 5539 P: 798</u>	<u>19^N 20^W</u>	<u>20</u>	<u>20 S.E. 21 N.W.</u>
<u>Mitchell no 4</u>	<u>394709</u>	<u>B: 7320 P: 786</u>	<u>19^N 20^W</u>	<u>20</u>	<u>20 N.W.</u>
<u>Mitchell no 5</u>	<u>394710</u>	<u>B: 7320 P: 788</u>	<u>19^N 20^W</u>	<u>20</u>	<u>20 S.W.</u>
<u>Leland no 4</u>	<u>394708</u>	<u>B: 7320 P: 784</u>	<u>19^N 20^W</u>	<u>20</u>	<u>17 S.W. 20 N.W.</u>
<u>Leland no 3</u>	<u>394711</u>	<u>B: 7320 P: 782</u>	<u>19^N 20^W</u>	<u>17</u>	<u>17 S.W. 17 S.E.</u>

BLM requires a \$5 nonrefundable service charge for each mining claim, mill site or tunnel site payable on or before December 30th (not the 31st). Mail to:

Bureau of Land Management
 222 North Central Avenue
 Phoenix, Arizona 85004-2203
 602-417-9200
 www.az.blm.gov

This form is for the purpose of complying with the laws of the United States Department of the Interior, Bureau of Land Management and the State of Arizona pertaining to assessment work and/or notice of intention to hold. 30 U.S.C. 28, 43 CFR 3833.2, ARS 27-208. Subject to Paperwork Reduction Act and Privacy Act statements available at the BLM AZ State Office. This form is not copyrighted. It may be reproduced without permission.

RECEIVED
BLM AZ STATE OFFICE
2010 DEC 21 A 7:46
PHOENIX, ARIZONA

BLM Date Stamp

United States Department of the Interior
Bureau of Land Management
 LANDS/RECREATION & PLANNING
 ONE N CENTRAL AVE
 PHOENIX, AZ 85004 -2203
 Phone:

Receipt

No:

2266699

Transaction #: 2338267	
Date of Transaction: 12/21/2010	
CUSTOMER:	
MAUREEN WALSH 6082 MOONLIGHT DR LAS VEGAS,NV 89130-1017 US	

LINE #	QTY	DESCRIPTION	REMARKS	UNIT PRICE	TOTAL
1	1.00	LOCATABLE MINERALS / MINING CLAIMS-NOT NEW-UNADJUD,ONE AUTH NO. ONLY / MINING CLAIM MONEY RECEIVED CASES: AMC364455/\$100.00	POL-10	- n/a -	100.00
TOTAL:					\$100.00

PAYMENT INFORMATION					
1	AMOUNT:	100.00	POSTMARKED:	N/A	
	TYPE:	CHECK	RECEIVED:	12/21/2010	
	CHECK NO:	3774			
	NAME:	WALSH, MAUREEN 6082 MOONLIGHT DR LAS VEGAS NV 89130-1017 US			

REMARKS

This receipt was generated by the automated BLM Collections and Billing System and is a paper representation of a portion of the official electronic record contained therein.

UNITED STATES
DEPARTMENT OF THE INTERIOR
BUREAU OF LAND MANAGEMENT

MAINTENANCE FEE WAIVER CERTIFICATION

225

Ame 364455
363097
364338
364822
394708

FORM APPROVED
OMB NO. 1004-0114
Expires: December 31, 2002

SEE INSTRUCTIONS ON REVERSE

1. This small miner waiver is filed for the assessment year beginning at noon on September 1, 10 and ending at noon on September 1, 11.
2. The undersigned and all related parties owned ten or fewer mining claims, mill, or tunnel sites located and maintained on Federal lands in the United States of America on September 1, 10.
3. The undersigned have performed the assessment work required by law for each mining claim listed prior to filing this waiver and understand that by filing this form; an affidavit of assessment work must be recorded by the December 30th following the filing of this waiver.
4. The undersigned understand that if the assessment work obligation has not yet come due under 30 U.S.C. 28 (for those claims in their first assessment year only); a notice of intent to hold reciting this condition must be recorded by the December 30th following the filing of this waiver.
5. The undersigned understand that mill and tunnel sites may also be listed upon this waiver and be waived from payment of the maintenance fee; and that a notice of intent to hold for these sites is required to be recorded by the December 30th immediately following the filing of this waiver.
6. The undersigned understand and acknowledge that pursuant to 43 U.S.C. 1212 and 18 U.S.C. 1001; the filing or recording of a false, fictitious, or fraudulent document with the Bureau of Land Management may result in a fine of up to \$250,000, a prison term not to exceed five years, or both.
7. The mining claims, mill or tunnel sites for which this waiver from payment of the maintenance fees is requested are:

CLAIM OR SITE NAME	BLM RECORDATION SERIAL NUMBER
1. <u>Brucite #1</u> ✓	<u>364455</u>
2. <u>Golden Gate</u>	<u>363097</u>
3. <u>Banner</u>	<u>363098</u>
4. <u>Mitchell #1</u>	<u>364338</u>
5. <u>Mitchell #2</u>	<u>364339</u>
6. <u>Mitchell #3</u>	<u>364822</u>
7. <u>Mitchell No 4</u>	<u>394709</u>
8. <u>Mitchell No 5</u>	<u>394710</u>
9. <u>Leland No 4</u>	<u>394708</u>
10. <u>Leland No 3</u>	<u>394711</u>

The owner(s) (claimants) of the above mining claims and sites are:

Maurcen Walsh ✓
(Owner's Name - Please Print)
6082 Moonlight Dr
(Street or P.O. Box)
Las Vegas NV 89130
(City) (State) (Zip Code)

Maurcen Walsh
(Owner's Signature)

(Owner's Name - Please Print)

(Street or P.O. Box)

(City) (State) (Zip Code)

(Owner's Signature)

(Owner's Name - Please Print)

(Street or P.O. Box)

(City) (State) (Zip Code)

ENTERED INTO COMPUTER

SEP 08 2010 *RB*

10/ps

(Owner's Name - Please Print)

(Street or P.O. Box)

(Owner's Name - Please Print)

(Street or P.O. Box)

(Owner's Name - Please Print)

(Street or P.O. Box)

(Owner's Name - Please Print)

(Street or P.O. Box)

(Owner's Signature)

(City)

(State)

(Zip Code)

(Owner's Signature)

(City)

(State)

(Zip Code)

(Owner's Signature)

(City)

(State)

(Zip Code)

(Owner's Signature)

(City)

(State)

(Zip Code)

INSTRUCTIONS

1. This certification is made under the provisions of § 1744 of Title 43 and § 28-28k of Title 30 of the United States Code; and the regulations thereunder (43 CFR Part 3830).
2. The claimant(s) must fill in the dates in paragraph 1 for the beginning and ending of the assessment year for which this waiver is sought.
3. The claimant(s) must fill in the date in paragraph 2 for the beginning of the assessment year for which this waiver is sought.
4. All claim and site names and Bureau of Land Management (BLM) serial numbers must be listed for the mining claims, mill sites, and tunnel sites for which the waiver is sought.
5. All owners of the mining claims, mill sites, and tunnel sites and their addresses must be given.
6. This waiver form must be signed by all the claimants or their designated agent, in original form. If an agent is designated, a notarized designation of agent, signed by all of the claimants with proper address given, must be submitted with this waiver.

7. This form must be filed no later than September 1st for the upcoming assessment year in the BLM State Office where the mining claims or sites are recorded, or the waiver cannot be granted by the BLM. (Example: to obtain a waiver for the assessment year 2000, which begins at noon on September 1, 1999, you must qualify for and file for a waiver no later than September 1, 1999 in the proper BLM State Office).
8. For all mining claims which require assessment work, you must record an affidavit of labor on or before the December 30th immediately following the filing of this waiver. For all other mining claims or sites waived, you must record a notice of intent to hold on or before the December 30th immediately following the filing of this waiver.
9. Mill and tunnel sites may also be listed upon this waiver and be waived from payment of the maintenance fee. A notice of intent to hold for these sites is required to be filed by the December 30th following the filing of this waiver.

NOTICE/BURDEN HOURS STATEMENT

The Privacy Act of 1974, as amended, and the regulation in 43 CFR 2.48(d) provide that you be furnished the following information in connection with the information required by this certification of waiver from rental fees.

AUTHORITY: 30 U.S.C. 28-28k; 43 U.S.C. 1201, 1457, 1740, and 1744; and 43 CFR 3830.

PRINCIPLE PURPOSE: This information is to be used to verify that the owner(s) (claimants) of a mining claim has complied with 30 U.S.C. 28f and is entitled to perform assessment work in lieu of paying the maintenance fee for the mining claims listed on this form.

ROUTINE USE: (1) Adjudication of the claimant(s) certification of waiver from paying the maintenance fee otherwise required by 30 U.S.C. 28f. (2) Disclosure may be made to appropriate Federal agencies when location is made within the agency's geographic area of responsibility. (3) Information from the record and/or the record will be transferred to the appropriate Federal, State, or local agency, or a member of the public in response to a specific request for pertinent information. (4) Information may also be provided to the Department of Justice or in a proceeding before a court or adjudicative body; or to Federal, State, local or foreign agencies when needed for enforcement of civil or criminal codes or applicable regulations concerning title rights upon the public land.

EFFECT OF NOT PROVIDING INFORMATION: Disclosure of this information is required by 30 U.S.C. 28f and 43 CFR Part 3830 for those qualified claimants wishing to take the small miner waiver allowed. Failure to supply the information required in this form to support the claimants certification of waiver from payment of the otherwise required maintenance fees will result in the waiver being disallowed and the mining claims subject to forfeiture by BLM under 30 U.S.C. 28i.

The Paperwork Reduction Act of 1995 requires us to inform you that:

This information is being collected to allow the BLM to determine if you qualify for a waiver from the payment of \$100 per mining claim or site maintenance fee established in 30 U.S.C. 28f and the implementing regulations at 43 CFR 3830. A response to this request is required in accordance with the statute to obtain your benefit.

BLM would like you to know that you do not have to respond to this, or any other, Federal agency-sponsored information collection unless it displays a currently valid OMB control number.

Public reporting burden for this form is estimated to average 8 minutes (0.133 hours) per response, including time to review instructions, gathering and maintaining data, and completing and reviewing the form. Direct comments regarding this burden estimate, or any other aspect of this form, to the U.S. Department of the Interior, Bureau of Land Management, (1004-0114) Bureau Clearance Officer (WO-630), Mail Stop 401 LS, 1849 C St., N.W., Washington, D.C. 20240.

FOR OFFICIAL USE ONLY

2010 AUG 11 P 2:45

RECEIVED
BLM STATE OFFICE

M. Walsh
6082 Moonlight Dr.
Las Vegas NV 89130



Place
stamp
here

RECEIVED
BLM AZ STATE OFFICE

2010 AUG 11 10:45
PHOENIX ARIZONA

Bureau of Land Management
One North Central Ave. Suite 800
Phoenix AZ 85004

B: 7650 P: 705

OFFICIAL RECORDS OF MOHAVE COUNTY CAROL MEIER, COUNTY RECORDER



12/11/2009 08:44 AM Fee: \$19.00 DOC TYPE: PL PAID BY: RICHARD SERETTA

A3850-1 (NOV. 2001)

No. of Claims: 10 x \$5 = 100.00 Receipt No.: 2055584 Check No.: 3140 Init: [Signature] FOR BLM USE ONLY

J AMC 364455 363099 364338 364827 394708

Return Document to: Maureen Walsh 6082 Moonlight Dr. Las Vegas N.V. 89130 Telephone: 702-645-3178

[X] AFFIDAVIT OF PERFORMANCE OF ANNUAL WORK. Also fill in Items 1 through 9 and the reverse side of this document.

[] NOTICE OF INTENTION TO HOLD. I intend to hold the claims(s)/site(s) listed on the reverse side of this document for the calendar year 20___. Also fill in Items 1 through 4 and Item 9.

Notices of Intention to Hold are for mill sites and tunnel sites or for mining claims when assessment work has not been done, regardless of whether the annual assessment has been suspended, deferred, or not yet accrued. The filing of a Notice of Intention to Hold shall not relieve the owner of complying with federal and state laws pertaining to the performance of annual assessment work. Notices of Intention to Hold for mill sites or tunnel sites need not be county recorded. For mining claims the form filed with the Bureau of Land Management (BLM) must be identical to the one that was or will be filed with the county.

Evidence of Annual Assessment Work or a Notice of Intention to Hold must be filed each calendar year following the calendar year in which the claim/site was located. All claims listed on a single affidavit must be contiguous.

- 1. State of Arizona, County of Mohave ss:
2. I, (Name) Maureen Walsh
3. Reside at (Address) 6082 Moonlight Dr. City Las Vegas, County Clark, State N.V. zip 89130

being duly sworn, deposes and says that he/she is a citizen of the United States, more than eighteen years of age, that all of the facts set forth in this affidavit/notice, subject to the provisions and penalties of 18 U.S.C. 1001 pertaining to the filing of false, fictitious, or fraudulent statements with the United States, are true and correct according to the best of my knowledge, information and belief.

4. Owner's name and address (If not shown in Items 1-3 above). Check here if this is a change of address. []

5. That I am personally acquainted with the mining claim(s). The work and improvements were made by and at the expense of the owner(s) of said claim(s). Said contiguous group of claims, listed on the reverse side of this document, are situated in the San Francisco Mining District, Mohave County, Arizona.

6. That between the dates starting at 12 o'clock noon on September 1, 2009 and ending at 12 o'clock noon on September 1, 2009 at least \$ 1100.00 Dollars worth of work and improvements were done and performed upon said claim(s) or upon one or more of a contiguous group of claims for the benefit of all, or wholly or partly outside of a contiguous group of claims for the benefit of all, not including the location work.

7. That the following persons were employed to perform the work and improvements described herein:

RECEIVED STATE OFFICE DEC 17 A 8:01



8. That the work and improvements performed were: Sampling ore dumps & Adits
Road Maintenance, Running Adits

9. Dated: 12/11/09 Signature: Maurice Walsh
 SUBSCRIBED AND SWORN TO before me, a Notary Public, this 11 day of December, 2009

by Margaret Elizabeth Walse
 Notary Public Sherie L. Sixkiller-Wing
 MY COMMISSION EXPIRES March 5, 2011

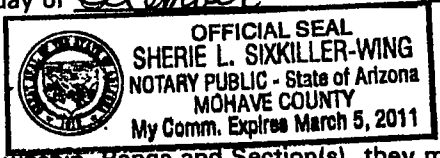

If the claims/sites have consecutive BLM numbers and are in the same Township, Range and Section(s), they may be listed as follows:

Claim/Site Name	Serial Number	Dkt/Pg or Record # of Orig Location Notice	TWN SHP	RNG	SEC(S)
Sample 1 - 10	A MC 19640 - 49	Dkt/Pg 1025/1-10 Recording #9106173-82	4N	20W	36
<u>Brucite # 1</u>	<u>L364455</u>	<u>B:5415 P:210</u>	<u>19^N20^W</u>	<u>17</u>	<u>5 S.E.</u>
<u>Golden Gate</u>	<u>L363097</u>	<u>B:5330 P:769</u> B:7029 P:455	<u>19^N20^W</u>	<u>20</u>	<u>21 N.E.</u>
<u>Banner</u>	<u>363098</u>	<u>B:5330 P:771</u>	<u>19^N20^W</u>	<u>20</u>	<u>21 N.E.</u>
<u>Mitchell # 1</u>	<u>L364338</u>	<u>B:5413 P:513</u>	<u>19^N20^W</u>	<u>20</u>	<u>N.W.</u>
<u>Mitchell # 2</u>	<u>364339</u>	<u>B:5413 P:511</u>	<u>19^N20^W</u>	<u>20</u>	<u>N.E.</u>
<u>Mitchell # 3</u>	<u>L364822</u>	<u>B:5539 P:798</u>	<u>19^N20^W</u>	<u>20</u>	<u>N.E. N.W.</u> <u>S.E. S.W.</u>
<u>Mitchell # 4</u>	<u>394709</u>	<u>B:7320 P:786</u>	<u>19^N20^W</u>	<u>20</u>	<u>N.W.</u>
<u>Mitchell # 5</u>	<u>394710</u>	<u>B:7320 P:788</u>	<u>19^N20^W</u>	<u>20</u>	<u>S.W.</u>
<u>Leland # 4</u>	<u>L394708</u>	<u>B:7320 P:784</u>	<u>19^N20^W</u>	<u>17</u>	<u>S.W. 20 N.</u>
<u>Leland # 3</u>	<u>394711</u>	<u>B:7320 P:782</u>	<u>19^N20^W</u>	<u>17</u>	<u>S.W.</u> <u>S.E.</u>

BLM requires a \$5 nonrefundable service charge for each mining claim, mill site or tunnel site payable on or before December 30th (not the 31st). Mail to:

Bureau of Land Management
 222 North Central Avenue
 Phoenix, Arizona 85004-2203
 602-417-9200
 www.az.blm.gov

This form is for the purpose of complying with the laws of the United States Department of the Interior, Bureau of Land Management and the State of Arizona pertaining to assessment work and/or notice of intention to hold. 30 U.S.C. 28, 43 CFR 3833.2, ARS 27-208. Subject to Paperwork Reduction Act and Privacy Act statements available at the BLM AZ State Office. This form is not copyrighted. It may be reproduced without permission.

BLM STATE OFFICE
 PHOENIX, ARIZONA
 2009 DEC 17 A 8:09

BLM Date Stamp

United States Department of the Interior
Bureau of Land Management
 BUSINESS & SUPPORT SVCS DIV
 ONE N CENTRAL AVE SUITE 800
 PHOENIX, AZ 85004 -4427
 Phone: (602) 417-9200

Receipt

No: 2055584

Transaction #: 2121646	
Date of Transaction: 12/17/2009	
CUSTOMER:	MAUREEN WALSH 6082 MOONLIGHT DR LAS VEGAS,NV 89130-1017 US

LINE #	QTY	DESCRIPTION	REMARKS	UNIT PRICE	TOTAL
1	1.00	LOCATABLE MINERALS / MINING CLAIMS- NOT NEW-UNADJUD, ONE AUTH NO. ONLY / MINING CLAIM MONEY RECEIVED CASES: AMC364455/\$100.00	POL (10)	- n/a -	100.00
TOTAL:					\$100.00

PAYMENT INFORMATION					
1	AMOUNT:	100.00	POSTMARKED:	12/14/2009	
	TYPE:	CHECK	RECEIVED:	12/17/2009	
	CHECK NO:	3140			
	NAME:	WALSH, MAUREEN 6082 MOONLIGHT DR LAS VEGAS NV 89130-1017 US			

REMARKS	

This receipt was generated by the automated BLM Collections and Billing System and is a paper representation of a portion of the official electronic record contained therein.

B: 7365 P: 239

RECEIVED
BLM AZ STATE OFFICE

2008 DEC 22 P 3:19

PHOENIX, ARIZONA

AMC 394708
AMC 363097
AMC 364338

OFFICIAL RECORDS
OF MOHAVE COUNTY
JOAN MCCALL,
COUNTY RECORDER



12/12/2008 08:26 AM Fee: \$19.00
DOC TYPE: PL
PAID BY: MAUREEN WALSH

Return Document to:

Maureen Walsh
6082 N. Moonlight Dr.
Las Vegas NV. 89130
Telephone: 702-645-3178

A3850-1(NOV.2001)

No. of Claims:	6	x \$	10	=	60.00
Receipt No.:	1814708	Check No.:	3229		
Init:	[Signature]				
FOR BLM USE ONLY					

AFFIDAVIT OF PERFORMANCE OF ANNUAL WORK. Also fill in Items 1 through 9 and the reverse side of this document.

NOTICE OF INTENTION TO HOLD. I intend to hold the claims(s)/site(s) listed on the reverse side of this document for the calendar year 20____. Also fill in Items 1 through 4 and Item 9.

Notices of Intention to Hold are for mill sites and tunnel sites or for mining claims when assessment work has not been done, regardless of whether the annual assessment has been suspended, deferred, or not yet accrued. The filing of a Notice of Intention to Hold shall not relieve the owner of complying with federal and state laws pertaining to the performance of annual assessment work. Notices of Intention to Hold for mill sites or tunnel sites need not be county recorded. For mining claims the form filed with the Bureau of Land Management (BLM) must be identical to the one that was or will be filed with the county.

Evidence of Annual Assessment Work or a Notice of Intention to Hold must be filed each calendar year following the calendar year in which the claim/site was located. All claims listed on a single affidavit must be contiguous.

1. State of Arizona, County of Mohave ss:
2. I, (Name) Maureen Walsh
3. Reside at (Address) 6082 N. Moonlight Dr.
City Las Vegas, County Clark, State NV. Zip 89130

being duly sworn, deposes and says that he/she is a citizen of the United States, more than eighteen years of age, that all of the facts set forth in this affidavit/notice, subject to the provisions and penalties of 18 U.S.C. 1001 pertaining to the filing of false, fictitious, or fraudulent statements with the United States, are true and correct according to the best of my knowledge, information and belief.

4. Owner's name and address (If not shown in Items 1-3 above). Check here if this is a change of address.

5. That I am personally acquainted with the mining claim(s). The work and improvements were made by and at the expense of the owner(s) of said claim(s). Said contiguous group of claims, listed on the reverse side of this document, are situated in the SAN FRANCISCO Mining District, Mohave County, Arizona.

6. That between the dates starting at 12 o'clock noon on September 1, 207 and ending at 12 o'clock noon on September 1, 208 at least \$ 700.00 Dollars worth of work and improvements were done and performed upon said claim(s) or upon one or more of a contiguous group of claims for the benefit of all, or wholly or partly outside of a contiguous group of claims for the benefit of all, not including the location work.

7. That the following persons were employed to perform the work and improvements described herein: _____

1/12/09 [Signature] ENTERED INTO COMPUTER

8. That the work and improvements performed were: Road work
Sampling, working Adit

9. Dated: 12-12-08 Signature: Lynne Gregor

SUBSCRIBED AND SWORN TO before me, a Notary Public, this 12th day of December, 2008
 by MAUREEN ELIZABETH WAUSH
 Notary Public Lynne Gregor
 MY COMMISSION EXPIRES 8/19/2011

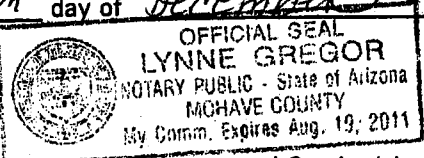

If the claims/sites have consecutive BLM numbers and are in the same Township, Range and Section(s), they may be listed as follows:

Claim/Site Name	Serial Number	Dkt/Pg or Record # of Orig Location Notice	TWN SHP RNG SEC(S)
Sample 1 - 10	A MC 19640 - 49	Dkt/Pg 1025/1-10 Recording #9106173-82	4N 20W 36
<u>Brucite #1</u>	<u>364455</u>	<u>5415</u> <u>B: 7029 P: 455</u>	<u>19N 20W 7 & 8</u>
<u>Golden Gate</u>	<u>363097</u>	<u>B: 7029 P: 455</u>	<u>19N 20W 21 & 20</u>
<u>Banner</u>	<u>363098</u>	<u>B: 7029 P: 455</u>	<u>19N 20W 20</u>
<u>Mitchell #1</u>	<u>364338</u>	<u>B: 7029 P: 455</u>	<u>19N 20W 20</u>
<u>Mitchell #2</u>	<u>364339</u>	<u>B: 7029 P: 455</u>	<u>19N 20W 20</u>
<u>Mitchell #3</u>	<u>364822</u>	<u>B: 5539 P: 798</u>	<u>19W 20W 20</u>

BLM requires a \$5 nonrefundable service charge for each mining claim, mill site or tunnel site payable on or before December 30th (not the 31st). Mail to:

Bureau of Land Management
 222 North Central Avenue
 Phoenix, Arizona 85004-2203
 602-417-9200
 www.az.blm.gov

This form is for the purpose of complying with the laws of the United States Department of the Interior, Bureau of Land Management and the State of Arizona pertaining to assessment work and/or notice of intention to hold. 30 U.S.C. 28, 43 CFR 3833.2, ARS 27-208. Subject to Paperwork Reduction Act and Privacy Act statements available at the BLM AZ State Office. This form is not copyrighted. It may be reproduced without permission.

RECEIVED
 BLM AZ STATE OFFICE
 2008 DEC 22 P 3:19
 PHOENIX, ARIZONA

BLM Date Stamp

B: 7365 P: 245

OFFICIAL RECORDS
OF MOHAVE COUNTY
JOAN MCCALL,
COUNTY RECORDER



12/12/2008 08:26 AM Fee: \$14.00
DOC TYPE: HOLD
PAID BY: MAUREEN WALSH

RECEIVED
BLM AZ STATE OFFICE

2008 DEC 22 P 3:19

PHOENIX, ARIZONA

NOTICE OF INTENTION TO HOLD MINING CLAIMS/SITES

When Recorded Return Document to:

Maureen Walsh
6082 N. Moonlight Dr
LAS VEGAS
NV. 89130

BLM
Date
Stamp

Check here if this is a change of address.

Telephone: 702-645-3178

E-mail Address _____

I (We) intend to hold the claims(s) and/or site(s) listed below for the calendar year 209 and I (We) have filed or will file a Notice of Intent to Hold in the county where the claim (s) is located.

Reason for filing a Notice of Intent to Hold instead of an assessment work filing (check one):

- Maintenance fee was paid to maintain claim(s) during this assessment year.
- Mill or tunnel sites.
- Claim(s) was located during the current assessment year.
- BLM has deferred assessment work (attach copy of decision granting deferment, or pending petition for deferment-including-date-petition-was filed.)

Line No.	AMC NUMBER	CLAIM/SITE NAME	COUNTY RECORDER DATA (if available)	TWP	RNG	SEC
1	394711	Leland N ^o 3	Mohave	19N	20W	17S.W
2	394708	Leland N ^o 4	Mohave	19N	20W	17S.W 20N.W
3	394709	Mitchell N ^o 4	Mohave	19N	20W	20N.W
4	394710	Mitchell N ^o 5	Mohave	19N	20W	20S.W
5						
6						
7						
8						
9						
10						

NOTICE OF INTENTION TO HOLD MINING CLAIMS/SITES
page 2

BLM
Date
Stamp

PHOENIX, ARIZONA

2008 DEC 22 P 3:19

RECEIVED
BLM AZ STATE OFFICE

1. State of Arizona, County of Mohave

2. I (Name) Maureen Walsh

3. Reside at (Address) 6082 N. Moonlight Dr.

City Las Vegas County Clark State NV Zip 89130 being duly sworn, depose and say that I am a citizen of the United States, more than eighteen years of age, that all of the facts set forth in this notice, subject to the provisions and penalties of 18 U.S.C. 1001 pertaining to the filing of false, fictitious, or fraudulent statements with the United States, are true and correct according to the best of my knowledge, information and belief.

4. Owner's name and address (If not shown in Items 1-3 above).

5. Dated: 12/12/08 Signature: Maureen Walsh

Bureau of Land Management
Arizona State Office
www.az.blm.gov

No. of Claims: 4 x \$10 = 40.00
Check No: 3229 Init. SM
Receipt No.: 1844708
For BLM Use Only

Form: MCF110
Revised Jan. 2006
Page 2 of 2

United States Department of the Interior
Bureau of Land Management
 BUSINESS & SUPPORT SVCS DIV
 ONE N CENTRAL AVE SUITE 800
 PHOENIX, AZ 85004 -4427
 Phone: (602) 417-9200

Receipt

No: 1844708

Transaction #: 1904411	
Date of Transaction: 12/23/2008	
CUSTOMER:	MAUREEN WALSH 6082 MOONLIGHT DR LAS VEGAS,NV 89130-1017 US

LINE #	QTY	DESCRIPTION	REMARKS	UNIT PRICE	TOTAL
1	1.00	LOCATABLE MINERALS / MINING CLAIMS-NOT NEW-UNADJUD,ONE AUTH NO. ONLY / MINING CLAIM MONEY RECEIVED CASES: AMC394711/\$100.00	NOI/POL	- n/a -	100.00
TOTAL:					\$100.00

PAYMENT INFORMATION					
1	AMOUNT:	100.00	POSTMARKED:	12/19/2008	
	TYPE:	CHECK	RECEIVED:	12/22/2008	
	CHECK NO:	3229			
	NAME:	WALSH, MAUREEN 6082 MOONLIGHT DR LAS VEGAS NV 89130-1017 US			

REMARKS

This receipt was generated by the automated BLM Collections and Billing System and is a paper representation of a portion of the official electronic record contained therein.

UNITED STATES
DEPARTMENT OF THE INTERIOR
BUREAU OF LAND MANAGEMENT

MAINTENANCE FEE WAIVER CERTIFICATION

SEE INSTRUCTIONS ON REVERSE

AMC 364455
AMC 363097
AMC 364338
AMC 364822
AMC 394708
RECEIVED
BLM AZ STATE OFFICE
FORM APPROVED
OMB NO. 1004-0114
Expires: December 31, 2002
2009 AUG 14 P 1:53
PHOENIX, ARIZONA
474

- This small miner waiver is filed for the assessment year beginning at noon on September 1, 09, and ending at noon on September 1, 10.
- The undersigned and all related parties owned ten or fewer mining claims, mill, or tunnel sites located and maintained on Federal lands in the United States of America on September 1, 09.
- The undersigned have performed the assessment work required by law for each mining claim listed prior to filing this waiver and understand that by filing this form; an affidavit of assessment work must be recorded by the December 30th following the filing of this waiver.
- The undersigned understand that if the assessment work obligation has not yet come due under 30 U.S.C. 28 (for those claims in their first assessment year only); a notice of intent to hold reciting this condition must be recorded by the December 30th following the filing of this waiver.
- The undersigned understand that mill and tunnel sites may also be listed upon this waiver and be waived from payment of the maintenance fee; and that a notice of intent to hold for these sites is required to be recorded by the December 30th immediately following the filing of this waiver.
- The undersigned understand and acknowledge that pursuant to 43 U.S.C. 1212 and 18 U.S.C. 1001; the filing or recording of a false, fictitious, or fraudulent document with the Bureau of Land Management may result in a fine of up to \$250,000, a prison term not to exceed five years, or both.
- The mining claims, mill or tunnel sites for which this waiver from payment of the maintenance fees is requested are:

CLAIM OR SITE NAME	BLM RECORDATION SERIAL NUMBER
1. <u>Brucite # 1</u>	<u>364455</u>
2. <u>Golden Gate</u>	<u>363097</u>
3. <u>Banner</u>	<u>363098</u>
4. <u>Mitchell # 1</u>	<u>364338</u>
5. <u>Mitchell # 2</u>	<u>364339</u>
6. <u>Mitchell # 3</u>	<u>364822</u>
7. <u>Leland No 3</u>	<u>394711</u>
8. <u>Leland No 4</u>	<u>394708</u>
9. <u>Mitchell No 4</u>	<u>394709</u>
10. <u>Mitchell No 5</u>	<u>394710</u>

The owner(s) (claimants) of the above mining claims and sites are:

Maureen Walsh
(Owner's Name - Please Print)
6082 Moonlight Dr
(Street or P.O. Box)
Las Vegas NV 89130
(City) (State) (Zip Code)

Maureen Walsh
(Owner's Signature)

(Owner's Name - Please Print)

(Street or P.O. Box)

(City) (State) (Zip Code)

(Owner's Signature)

(Owner's Name - Please Print)

(Street or P.O. Box)

(City) (State) (Zip Code)

ENTERED IN COMPUTER
82 9/22/09

(Owner's Name - Please Print)

(Owner's Signature)

(Street or P.O. Box)

(City)

(State)

(Zip Code)

(Owner's Name - Please Print)

(Owner's Signature)

(Street or P.O. Box)

(City)

(State)

(Zip Code)

(Owner's Name - Please Print)

(Owner's Signature)

(Street or P.O. Box)

(City)

(State)

(Zip Code)

(Owner's Name - Please Print)

(Owner's Signature)

(Street or P.O. Box)

(City)

(State)

(Zip Code)

INSTRUCTIONS

1. This certification is made under the provisions of § 1744 of Title 43 and § 28-28k of Title 30 of the United States Code; and the regulations thereunder (43 CFR Part 3830).
2. The claimant(s) must fill in the dates in paragraph 1 for the beginning and ending of the assessment year for which this waiver is sought.
3. The claimant(s) must fill in the date in paragraph 2 for the beginning of the assessment year for which this waiver is sought.
4. All claim and site names and Bureau of Land Management (BLM) serial numbers must be listed for the mining claims, mill sites, and tunnel sites for which the waiver is sought.
5. All owners of the mining claims, mill sites, and tunnel sites and their addresses must be given.
6. This waiver form must be signed by all the claimants or their designated agent, in original form. If an agent is designated, a notarized designation of agent, signed by all of the claimants with proper address given, must be submitted with this waiver.

7. This form must be filed no later than September 1st for the upcoming assessment year in the BLM State Office where the mining claims or sites are recorded, or the waiver cannot be granted by the BLM. (Example: to obtain a waiver for the assessment year 2000, which begins at noon on September 1, 1999, you must qualify for and file for a waiver no later than September 1, 1999 in the proper BLM State Office).
8. For all mining claims which require assessment work, you must record an affidavit of labor on or before the December 30th immediately following the filing of this waiver. For all other mining claims or sites waived, you must record a notice of intent to hold on or before the December 30th immediately following the filing of this waiver.
9. Mill and tunnel sites may also be listed upon this waiver and be waived from payment of the maintenance fee. A notice of intent to hold for these sites is required to be filed by the December 30th following the filing of this waiver.

NOTICE/BURDEN HOURS STATEMENT

The Privacy Act of 1974, as amended, and the regulation in 43 CFR 2.48(d) provide that you be furnished the following information in connection with the information required by this certification of waiver from rental fees.

AUTHORITY: 30 U.S.C. 28-28k; 43 U.S.C. 1201, 1457, 1740, and 1744; and 43 CFR 3830.

PRINCIPLE PURPOSE: This information is to be used to verify that the owner(s) (claimants) of a mining claim has complied with 30 U.S.C. 28f and is entitled to perform assessment work in lieu of paying the maintenance fee for the mining claims listed on this form.

ROUTINE USE: (1) Adjudication of the claimant(s) certification of waiver from paying the maintenance fee otherwise required by 30 U.S.C. 28f. (2) Disclosure may be made to appropriate Federal agencies when location is made within the agency's geographic area of responsibility. (3) Information from the record and/or the record will be transferred to the appropriate Federal, State, or local agency, or a member of the public in response to a specific request for pertinent information. (4) Information may also be provided to the Department of Justice or in a proceeding before a court or adjudicative body; or to Federal, State, local or foreign agencies when needed for enforcement of civil or criminal codes or applicable regulations concerning title rights upon the public land.

EFFECT OF NOT PROVIDING INFORMATION: Disclosure of this information is required by 30 U.S.C. 28f and 43 CFR Part 3830 for those qualified claimants wishing to take the small miner waiver allowed. Failure to supply the information required in this form to support the claimants certification of waiver from payment of the otherwise required maintenance fees will result in the waiver being disallowed and the mining claims subject to forfeiture by BLM under 30 U.S.C. 28i.

The Paperwork Reduction Act of 1995 requires us to inform you that:

This information is being collected to allow the BLM to determine if you qualify for a waiver from the payment of \$100 per mining claim or site maintenance fee established in 30 U.S.C. 28f and the implementing regulations at 43 CFR 3830. A response to this request is required in accordance with the statute to obtain your benefit.

BLM would like you to know that you do not have to respond to this, or any other, Federal agency-sponsored information collection unless it displays a currently valid OMB control number.

Public reporting burden for this form is estimated to average 8 minutes (0.133 hours) per response, including time to review instructions, gathering and maintaining data, and completing and reviewing the form. Direct comments regarding this burden estimate, or any other aspect of this form, to the U.S. Department of the Interior, Bureau of Land Management, (1004-0114) Bureau Clearance Officer (WO-630), Mail Stop 401 LS, 1849 C St., N.W., Washington, D.C. 20240.

FOR OFFICIAL USE ONLY

NOTICE!!

These documents have been scanned!

Do not place un-scanned documents beneath this notice!

Do not remove this notice from this file!

GPO Jacket No. 560-102
Print Order 61540
Rise Business Services, LLC
Job=AZ15 5/22/2019



Box Number= AZ15079



Claim Begin-End: AMC394708-AMC394711

5 Miscellaneous



AZ15079-13

AMC394407-AMC394878

**NO
DOCUMENTS
FOUND**

NO DOCUMENTS FOUND
NO DOCUMENTS FOUND

NOTICE!!

These documents have been scanned!

Do not place un-scanned documents beneath this notice!

Do not remove this notice from this file!

GPO Jacket No. 560-102
Print Order 61540
Rise Business Services, LLC
Job=AZ15 5/22/2019



Box Number= AZ15079



Claim Begin-End: AMC394708-AMC394711

6 Location Notices-Amendments and Supporting Documents



AZ15079-13

AMC394407-AMC394878

MINING CLAIM STATUS REPORT

DATA ENTRY _____

MTP CHECKED BY _____

GEO CHECKED BY _____

LEAD SERIAL NO. AMC 394708 THROUGH AMC 394711

# <u>4</u>	LODE	LOCATION FEE @ \$30 =	\$ _____
# _____	PLACER	PROCESSING FEE @ \$15 =	\$ _____
# _____	ASSOCIATION PL	MAINTENANCE FEE @ \$125 =	\$ _____
# _____	MILL SITE	OVERAGE	\$ _____
# _____	TUNNEL SITE	SHORTAGE	\$ _____
		OTHER FEES	\$ _____
		TOTAL	\$ _____

ENOUGH LOCATORS YES [] NO []

OVER-THE-COUNTER [] MAIL [] TIMELY FILED: YES [] NO []

LEGAL DESCRIPTION: T 19N R 20W SEC 17, 20

T _____ R _____ SEC _____

T _____ R _____ SEC _____

T _____ R _____ SEC _____

BLM [] FOREST SERVICE [] _____ SUBJ TO PL 359: YES [] NO []

WILDERNESS AREA: NO [] YES [] _____

SPLIT ESTATE: SX [] PX [] SRHA [] OTHER [] _____ N/A []
PROPER NOTICE FILED IF LOCATED ON SRHA LANDS-YES [] NO [] N/A []

RECONVEYED MINERALS ON BLM LANDS REQUIRE OPENING ORDERS FROM 1944 TO 1993. OPEN TO ENTRY ON: _____ N/A []

COMMENTS/STATUS: VOID [] PARTIALLY VOID [] PVT MINERALS []
WITHDRAWN LANDS [] OTHER [] _____

Claimant acknowledges that portions of the following claim(s) site(s) may be void or voidable. _____

Signature of claimant _____
FINAL ADJUDICATION 08 DATE 12/31/09

AMC 394708

When recorded, mail to:

Name: MAUREEN WALSH

Address: 6082

N. MOONLIGHT DR.

City/State/Zip Code: LAS VEGAS

NV. 89130

Space above this line for Recorder's use

NOTICE OF MINING CLAIM.

RECEIVED
BLM AZ STATE OFFICE
PHOENIX, ARIZONA
08 SEP 22 A 7:17

- 1. TYPE OF NOTICE: Location Amendment Relocation
- 2. TYPE OF CLAIM: Placer Lode Millsite Tunnel
- 3. The name and address of the Locator is

Name: MAUREEN WALSH
 Address: 6082 N. MOONLIGHT DR.
 City/State/Zip Code: LAS VEGAS NV. 89130

- 4. The name of the claim is LELAND No 4
- 5. The date of the location is Sept. 2, 08
- 6. The claim is 1500 feet long and 600 feet wide. The distance from the location monument to each end of the claim is 10 feet in a west EAST direction and 590 feet in a WEST direction.
- 7. The general course of the claim is from the NORTH to the SOUTH
- 8. The location of the claim is in Section sw 17 & 20 nw, Township 19 N Range 20 W

GILA AND SALT RIVER Base and Meridian,
SAN FRANCISCO Mining District, MOHAVE County,
 State of AZ.

- 9. If amending or relocating, the previous claim name was _____ recorded in Docket(Book) _____ page(s) _____ Mining District, _____ County, State of _____

- 10. The location of the claim with reference to a natural object or permanent monument is THE SOUTH EAST SIDE LINES WITH THE SOUTH END of Patent LELAND No 2

Dated: September 15, 2008

Maureen Walsh
6082 N Moonlight Dr.
Las Vegas, NV 89130
 City/State/Zip

AMC 3914708

MAP OF MINING CLAIM LOCATION

1. The name of the claim is LELAND No 4;
2. The SOUTH EAST corner of the claim is 300 feet in a NORTH direction to a survey monument or permanent natural object described as SOUTH WEST CORNER PATENT LELAND NO 2;
3. The type of location monument is 1 3/4 GAL. STEEL PIPE;
The type of corner end monuments are 1 3/4 GAL. STEEL PIPE;
4. The bearing and distance between the corners of the claim are beginning at the SOUTH EAST corner of the claim, 600 feet in a WEST direction to the SOUTH WEST corner, then 1500 feet in a NORTH direction to the NORTH WEST corner, then 600 feet in a EAST direction to the NORTH EAST corner, then 1500 feet in a SOUTH direction to the point of beginning.

MAP

One inch = One thousand feet

North Arrow



ONE MILE

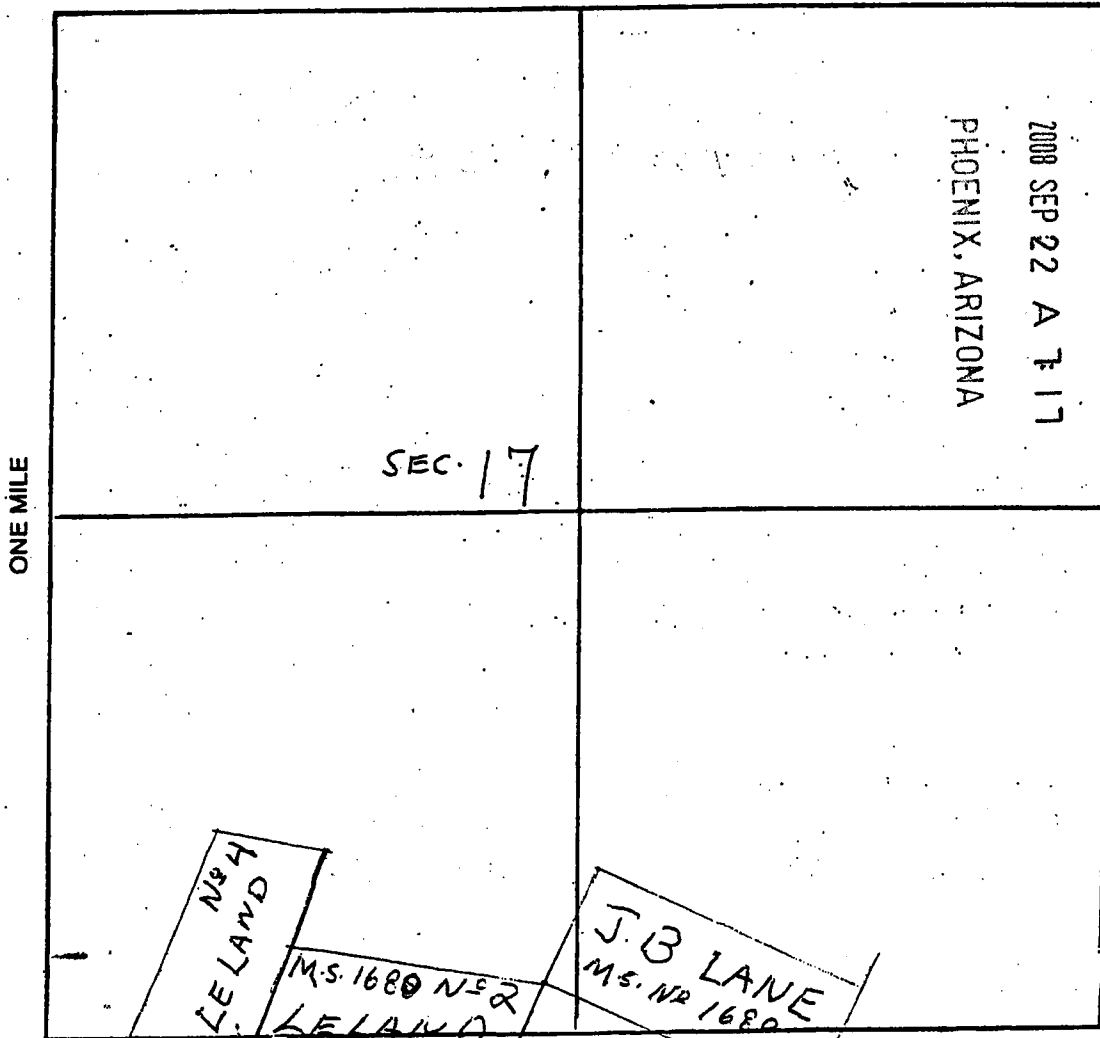

Section 17 SW 20 NW Range 20 W Township 19 N

GILA AND SALT RIVER Range and Meridian.

Dated: September 15, 2008

(SEC. 20)

Maureen Walsh
Signature

When recorded, mail to:

Name: MAUREEN WALSH

Address: 6082 N. Moonlight Dr.

City/State/Zip Code: LAS VEGAS

NV 89130 702-6453178

Space above this line for Recorder's use

NOTICE OF MINING CLAIM.

RECEIVED
BLM AZ STATE OFFICE
2008 SEP 22 A 11 17
PHOENIX, ARIZONA

- 1. TYPE OF NOTICE: Location Amendment Relocation
- 2. TYPE OF CLAIM: Placer Lode Millsite Tunnel site
- 3. The name and address of the Locator is:
Name: MAUREEN WALSH
Address: 6082 N. MOONLIGHT DR.
City/State/Zip Code: LAS VEGAS NV 89130
- 4. The name of the claim is MITCHELL No 4
- 5. The date of the location is Sept. 2, 08
- 6. The claim is 1500 feet long and 600 feet wide. The distance from the location monument to each end of the claim is 10 feet in a NORTH direction and 590 feet in a SOUTH direction.
- 7. The general course of the claim is from the EAST to the WEST
- 8. The location of the claim is in Section 20 NW, Township 19 N, Range 20 W, GILA AND SALT RIVER Base and Meridian, SAN FRANCISCO Mining District, MOHAVE County, State of ARIZONA
- 9. If amending or relocating, the previous claim name was _____ recorded in Docket(Book) _____ page(s) _____ Mining District, _____ County, State of _____

10. The location of the claim with reference to a natural object or permanent monument is THE NORTH EAST CORNER IS APPROX. 1050' SOUTH OF SURVEY MARKER OF MITCHELL'S M.S. NO 1680 SOUTH WEST CORNER ALSO ON THE NORTH SIDELINES MITCHELL'S AMC 364339 AND ON EAST ENDOINES WITH MITCHELL NO 3 AMC 36482

Dated: September 15, 2008

Maureen Walsh
6082 N Moonlight Dr
Las Vegas NV 89130
City/State/Zip

AMC 364339 709

MAP OF MINING CLAIM LOCATION

1. The name of the claim is MITCHELL N# 4
2. The NORTH EAST corner of the claim is 1050 feet in a SOUTH direction to a survey monument or permanent natural object described as SOUTH WEST CORNER OF MITCHELL M.S. N# 1680
3. The type of location monument is 1 3/4 GALV. PIPE
The type of corner end monuments are 1 3/4 GALV. PIPE
4. The bearing and distance between the corners of the claim are beginning at the NORTH EAST corner of the claim, 600 feet in a SOUTH direction to the SOUTH EAST corner, then 1500 feet in a WEST direction to the SOUTH WEST corner, then 600 feet in a NORTH direction to the NORTH WEST corner, then 1500 feet in a EAST direction to the point of beginning.

MAP

One Inch = One thousand feet

North Arrow



ONE MILE

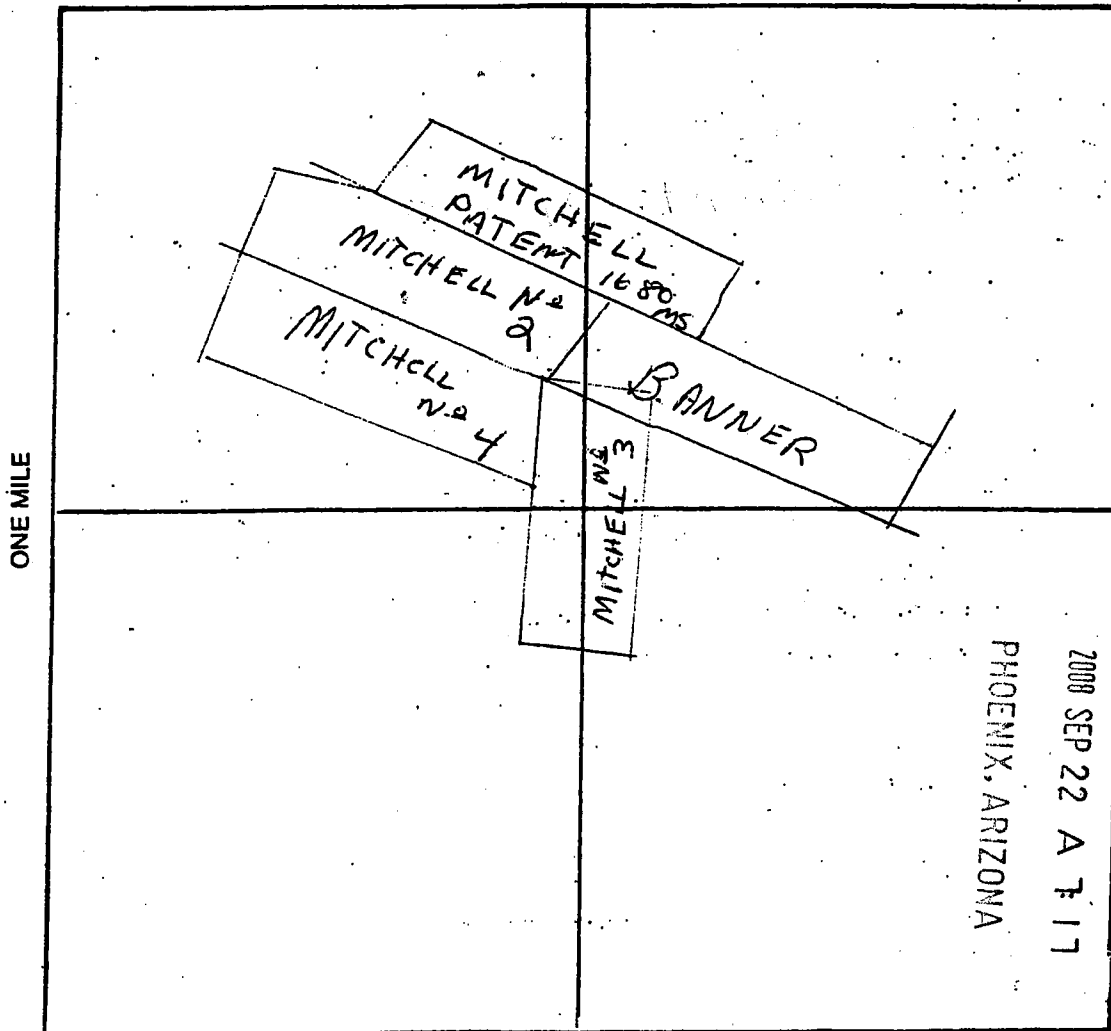

Section 20 NW Range 20 W Township 19 N
GILA AND SALT RIVER Base and Meridian
 Dated: September 15, 2008 Theresa Walsh
 Signature

When recorded, mail to:

Name: MAUREEN WALSH

Address: 6082 N MOONLIGHT DR
LAS VEGAS N.V.

City/State/Zip Code: 89130

702-6453178

Space above this line for Recorder's use

NOTICE OF MINING CLAIM.

RECEIVED
BLM AZ STATE OFFICE
2008 SEP 22 A 7:18
PHOENIX ARIZONA

- 1. TYPE OF NOTICE: Location Amendment Relocation
- 2. TYPE OF CLAIM: Placer Lode Millsite Tunnel site

3. The name and address of the Locator is

Name: MAUREEN WALSH

Address: 6082 N. MOONLIGHT DR.

City/State/Zip Code: LAS VEGAS N.V. 89130

4. The name of the claim is MITCHELL N^o 5

5. The date of the location is Sept. 2, 08

6. The claim is 1500 feet long and 600 feet wide. The distance from the location monument to each end of the claim is 10 feet in a WEST direction and 590 feet in a EAST direction.

7. The general course of the claim is from the NORTH to the SOUTH

8. The location of the claim is in Section 20 N.W., Township 19 N, Range 20 W

GILA AND SALT RIVER Base and Meridian
SAN FRANCISCO Mining District, MOHAVE County
State of ARIZONA

9. If amending or relocating, the previous claim name was _____ recorded in Docket(Book) _____ page(s) _____ Mining District, _____ County, State of _____

10. The location of the claim with reference to a natural object or permanent monument is THE NORTH WEST CORNER 1300' NORTH OF SURVEY POST OF MITCHELLS M.S. 1680 SOUTH WEST CORNER NORTH END SIDELINES MITCHELL N^o 4 SOUTH EAST CORNER THE EAST SIDELINES MITCHELL N^o 7 WEST SIDELINE.

Dated: September 15, 2008

Maureen Walsh
6082 N Moonlight Dr
Las Vegas NV 89130
City/State/Zip

AMC 3914710

MAP OF MINING CLAIM LOCATION

- The name of the claim is MITCHELL N^o 5
- The NORTHWEST corner of the claim is 1300 feet in a NORTH direction to a survey monument or permanent natural object described as M.S. 1680 MITCHELL SOUTH WEST CORNER POST
- The type of location monument is 1 1/2 GAL. STEEL PIPE
The type of corner end monuments are 1 1/2 GAL. STEEL PIPE
- The bearing and distance between the corners of the claim are beginning at the NORTH EAST corner of the claim, 1350 feet in a SOUTH direction to the SOUTH EAST corner, then 600 feet in a WEST direction to the SOUTH WEST corner, then 1500 feet in a NORTH direction to the NORTH WEST corner, then 600 feet in a EAST direction to the point of beginning.

MAP

One inch = One thousand feet

North Arrow



ONE MILE

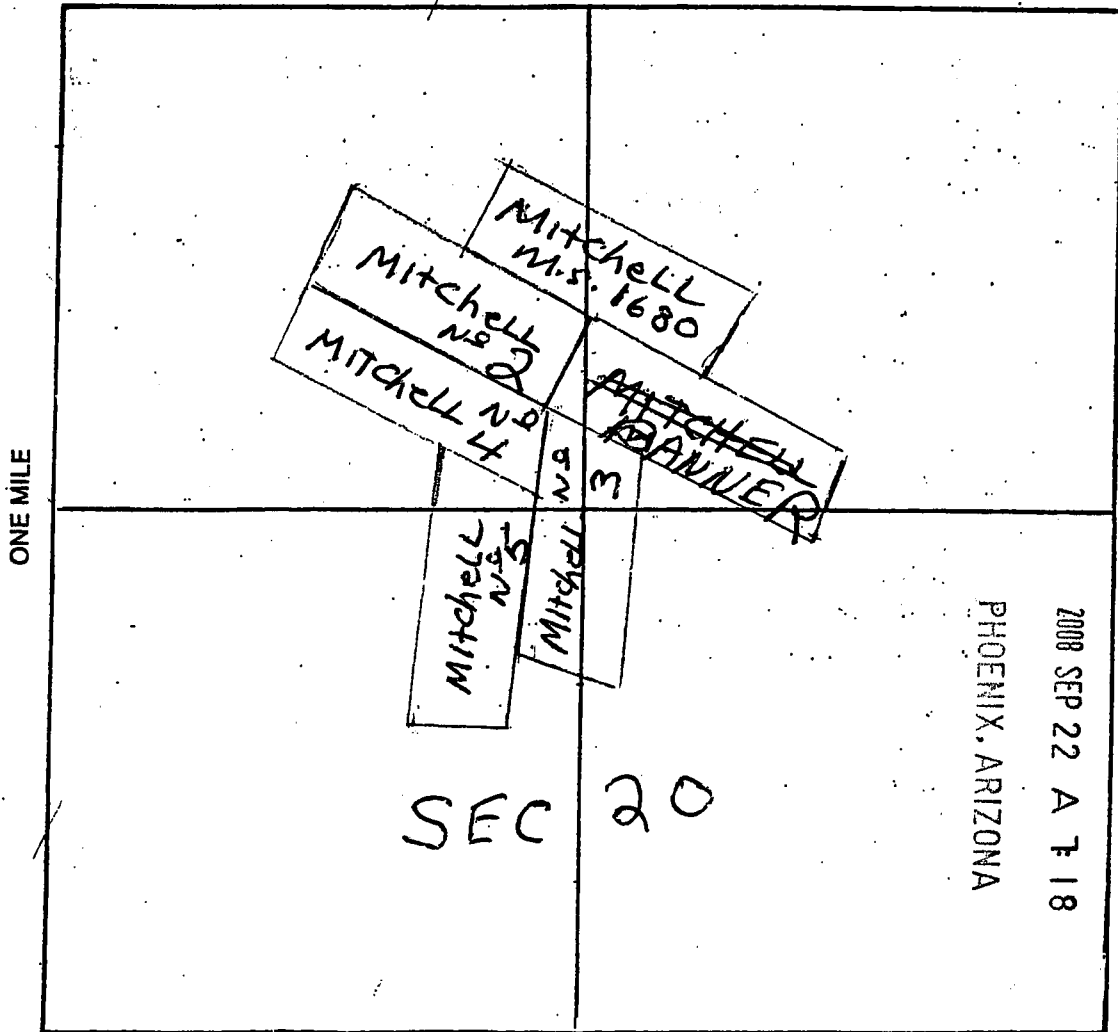

Section 20 N.W 20 S.W Range 20 W Township 19 N
GILA AND SALT RIVER Base and Meridian
 Dated: September 15, 2008 Signature Lawrence Walsh

When recorded, mail to:

Name: MAUREEN WALSH

Address: 6082

N. MOONLIGHT DR.

City/State/Zip Code: LAS VEGAS

NV. 89130

RECEIVED
BLM AZ STATE OFFICE
2008 SEP 22 A 7:17
PHOENIX, ARIZONA

Space above this line for Recorder's use

NOTICE OF MINING CLAIM.

1. TYPE OF NOTICE: Location Amendment Relocation

2. TYPE OF CLAIM: Placer Lode Millsite Tunnelsite

3. The name and address of the Locator is

Name: MAUREEN WALSH

Address: 6082 N. MOONLIGHT DR.

City/State/Zip Code: LAS VEGAS NV. 89130

4. The name of the claim is LELAND #3

5. The date of the location is Sept. 2, 08

6. The claim is 1500 feet long and 600 feet wide. The distance from the location monument to each end of the claim is 10 feet in a EAST direction and 1490 feet in a WEST direction.

7. The general course of the claim is from the EAST to the WEST

8. The location of the claim is in Section 17 SW SE, Township 19 N, Range 20 W

GILA AND SALTRIVER Base and Meridian,
SAN FRANCISCO Mining District, MOHAVE County,
State of AZ.

9. If amending or relocating, the previous claim name was _____ recorded in Docket(Book) _____ page(s) _____ Mining District, _____ County, State of _____

10. The location of the claim with reference to a natural object or permanent monument is THE EAST END LINES WITH THE WEST END OF PATENT J.B LANE THE SOUTH SIDE LINES WITH NORTH SIDE OF PATENT LELAND #2

Dated: September 15, 2008

Maurcen Walsh
6082 N Moonlight Dr.
Las Vegas NV 89130
City/State/Zip

ME394711

MAP OF MINING CLAIM LOCATION

1. The name of the claim is LELAND 3[#]
2. The SOUTH EAST corner of the claim is 1 feet in a NORTH direction to a survey monument or permanent natural object described as NORTH EAST CORNER OF PATENT LELAND 2[#]
3. The type of location monument is "1 3/4 STEEL PIPE
The type of corner end monuments are "1 3/4 STEEL PIPE
4. The bearing and distance between the corners of the claim are beginning at the SE corner of the claim, 1500 feet in a WEST direction to the SOUTH WEST corner, then 600 feet in a NORTH direction to the NORTH WEST corner, then 1500 feet in a EAST direction to the NORTH EAST corner, then 600 feet in a SOUTH direction to the point of beginning.

MAP

One inch = One thousand feet

North Arrow



ONE MILE

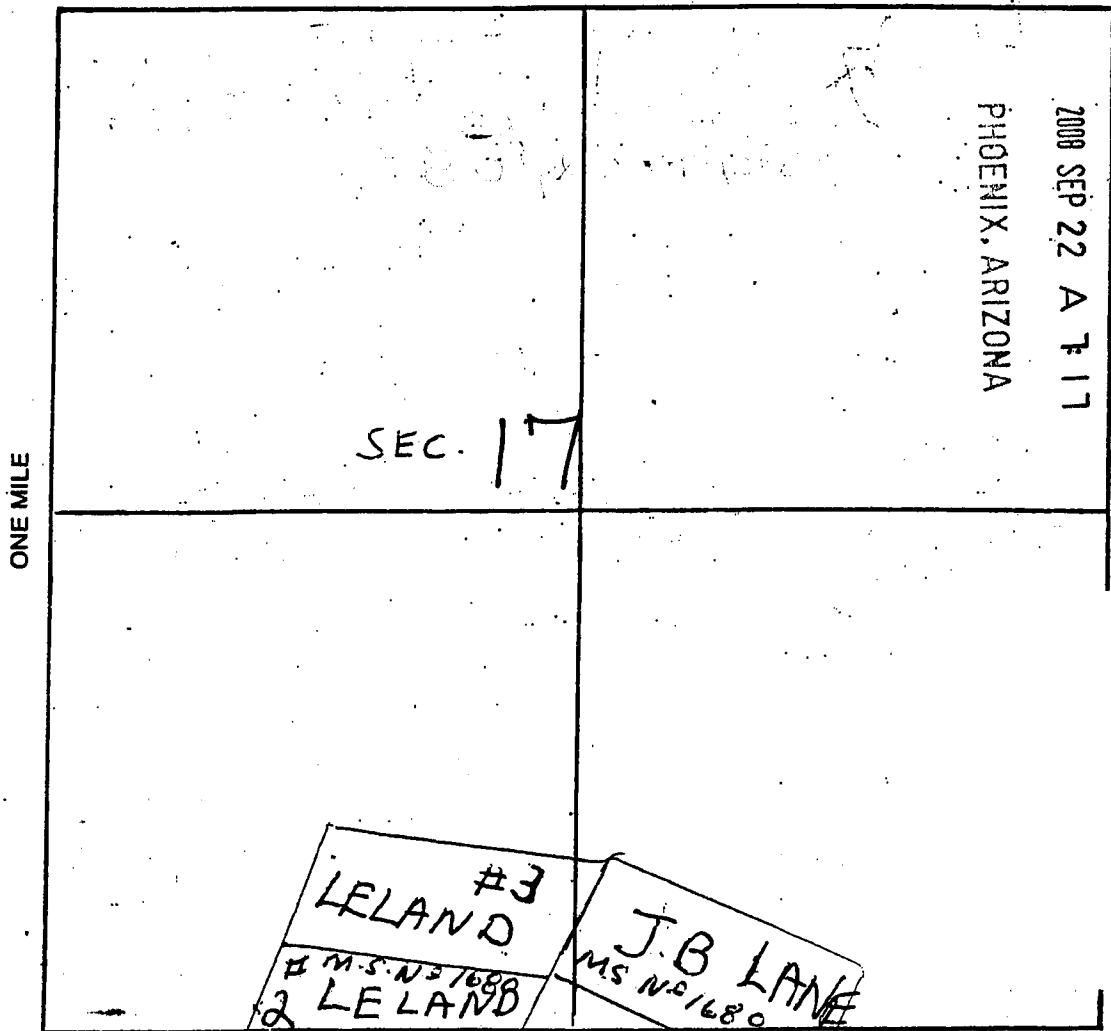

RECEIVED
 BLM AZ STATE OFFICE
 640 ACRES
 2008 SEP 22 A 7:17
 PHOENIX, ARIZONA

Section 17 SW SE Range 20 W Township 19 N
GILA AND SALT RIVER Base and Meridian.
 Dated: September 15, 2008 Signature Maurice Wash

11/15/08
 11/15/08
 11/15/08

DEPARTMENT OF INTERIOR
BUREAU OF LAND MANAGEMENT

Input Parameters for Geographic Report with Land

System Id = CR

Admin State = AZ

Geo State = AZ

Casetype Begins With

Case Disp Txt = AUTHORIZED, CANCELLED, EXPIRED, PENDING, REJECTED, RELINQUISHED, WITHDRAWN

Mer Twp Rng = 14 0190N 0200W

Section = 017, 020

Mtrs =

Commodity =

Commodity Txt =

Pending Org =

Pend Org Decode =

Total Rows Returned: 2

RUN TIME: 09:21 AM

Adm State: AZ

UNITED STATES DEPARTMENT OF INTERIOR
BUREAU OF LAND MANAGEMENT
GEOGRAPHIC REPORT WITH LAND
Sorted by Meridian Township Range

RUN DATE: 09/29/2008
Page 1 of 1

Serial Number: AZA 030739

Total Case Acres: 1.000

<u>Casetype</u>	<u>Case Disp</u>				<u>Sect</u>	<u>Sur Typ</u>	<u>Sur Num</u>	<u>Suff</u>	<u>Subdivision</u>	<u>Act Pend</u>
380913	AUTHORIZED	14	0190N	0200W	017	ALIQ			NW;	Y

Serial Number: AZAR 0023662

Total Case Acres: 164.600

<u>Casetype</u>	<u>Case Disp</u>				<u>Sect</u>	<u>Sur Typ</u>	<u>Sur Num</u>	<u>Suff</u>	<u>Subdivision</u>	<u>Act Pend</u>
288100	AUTHORIZED	14	0190N	0200W	020	FF		1	SESE;	

